

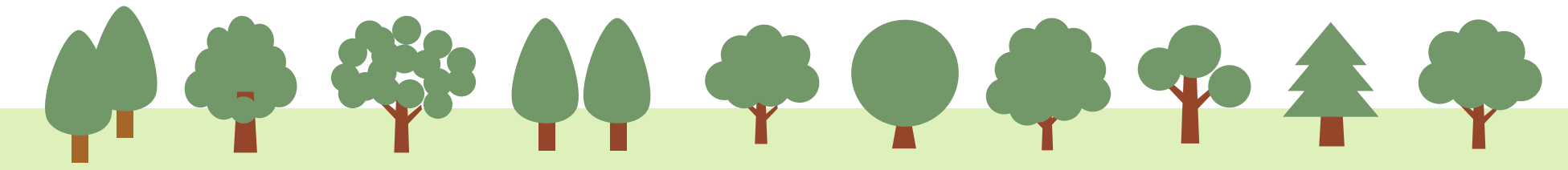



EASTBOURNE PARK





Eco Space Concept Plan: A Bramalea SNAP Initiative

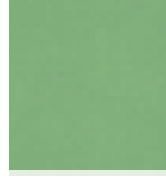
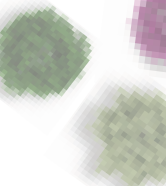

LEGEND

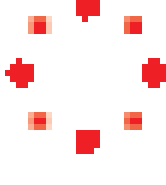
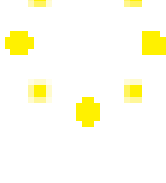
-  **Naturalized Area**
Marginal spaces that can be added to naturalization projects (i.e. No Mow Program)
-  **Mimico Creek Channel Restoration**
Mimico Creek channel restoration area, stipulated by TRCA and including removal of the concrete lining and re-naturalization of the creek and its banks.
-  **Pollinator Habitat**
Large areas for the creation of habitat, including host species, food sources, and other habitats (i.e. logs, rocks for water sources, etc.)
-  **Lawn**
Sodded areas for passive human recreation.
-  **New Tree Canopy**

Potential Eco Park Amenities

-  **Removal of Cement Pad**
-  **Log Benches**
-  **Creek Lookout**
-  **Tiny Forest/Outdoor Classroom**
This space is proposed for a tiny forest, with a centralized outdoor classroom where learning will be in and around nature.
-  **Play Node**
Proposed in a large clearing of trees, this could be an interactive "mini-park," a space where parents can sit around the perimeter, while children enjoy a natural themed play experience - To be implemented contingent on funding.
-  **Playground Revitalization**
The site for the playground update and revitalization.

Further amenities such as waste receptacles, artwork, interpretive signs, etc. will be explored based on availability of funding.

*For conceptual purposes only and based upon funding availability and construction



Scan to Learn More



Or visit
www.brampton.ca/ecopark

GRAB A POST-IT AND SHARE YOUR THOUGHTS AND COMMENTS!

What is a TINY FOREST ?

A small area, typically the size of a tennis court, densely packed with native trees and shrubs.

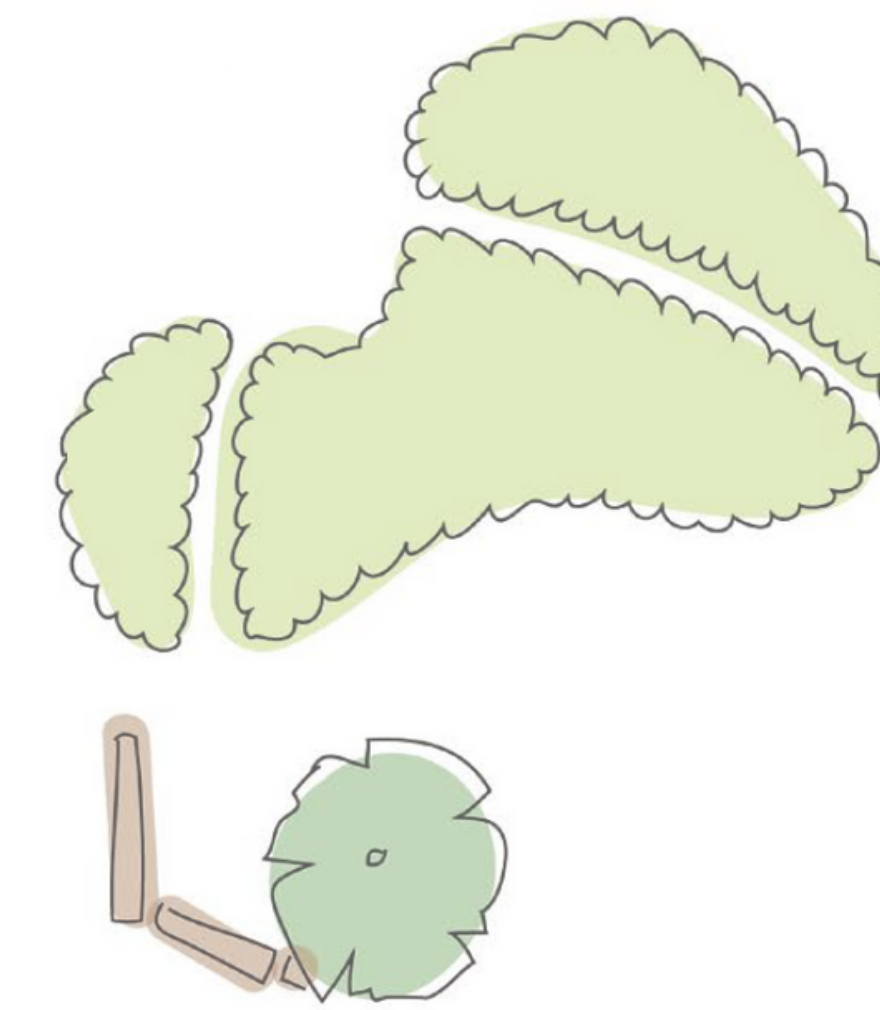
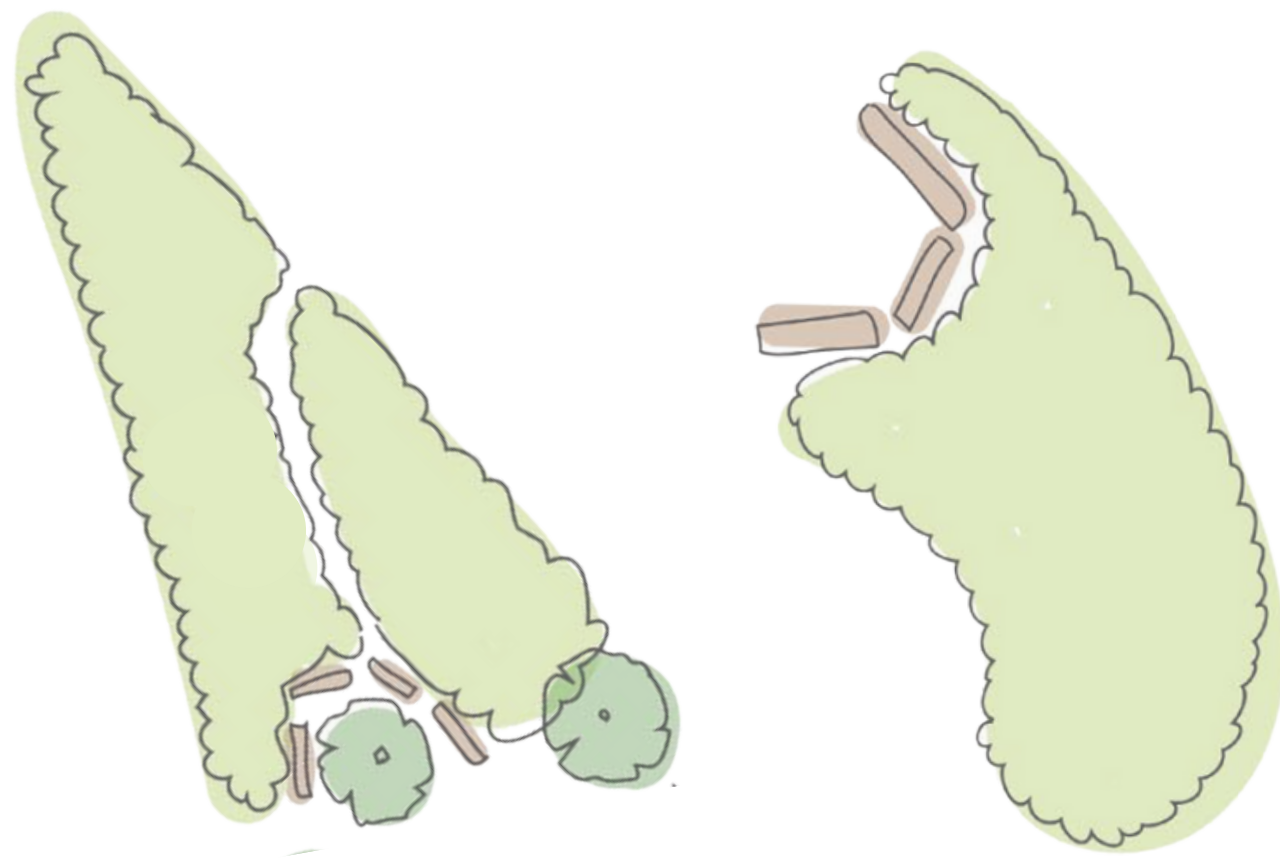

Reduces heat stress

Improves water storage capacity and reduces flood risk

Improves the mental, physical and emotional health of visitors

Provides an outdoor classroom for children to reconnect with nature

Attracts butterflies, birds, bees & small mammals

Regulates temperature and benefits the city climate

Creates a place for people and neighbours to come together

Includes diverse native plants & trees are better able to deal with natural disasters

Improves air quality

Provides people with access to nature which helps reduce stress



GRAB A POST-IT AND SHARE YOUR THOUGHTS !

Learn More:



Source: National Geographic



Most images and some graphics are from IVN Natuur Educatie, being used for conceptual purposes only and may vary upon construction.

