

APPENDIX

P

PRELIMINARY
ROAD DESIGN
(PLAN AND
PROFILE)
DRAWINGS

APPENDIX

P-6 HIGHWAY 50, ARTERIAL A2 AND MAJOR MACKENZIE - ULTIMATE DESIGN

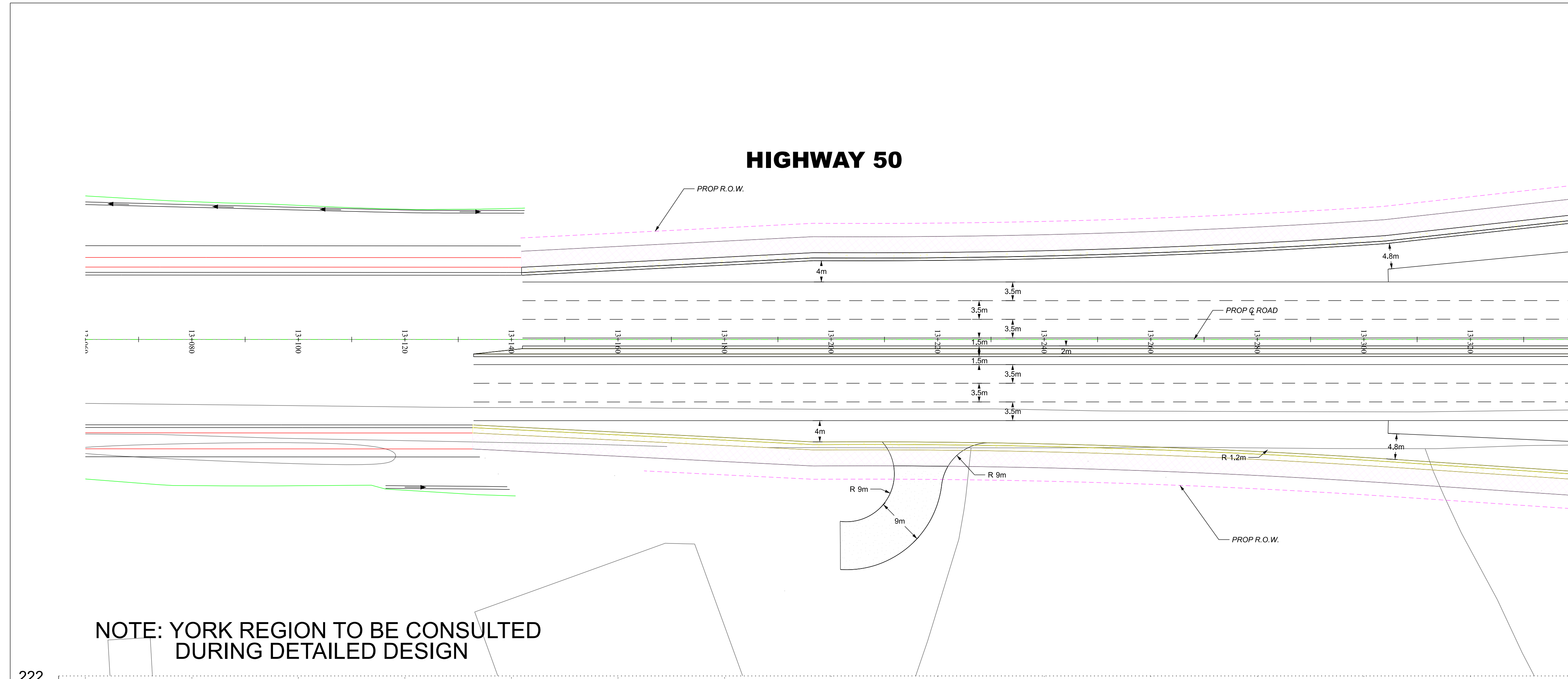

NOTE: YORK REGION TO BE CONSULTED DURING DETAILED DESIGN

FUTURE ROAD ELEVATION AND GRADING OF THE PROPOSED INTERCHANGE TO BE CONFIRMED AND MATCHED TO THE EXISING AND/OR FUTURE ELEVATION/GRADING OF HIGHWAY 50 & MAJOR MACKENZIE INTERSECTION DURING DETAILED DESIGN.

FUTURE HIGHWAY 50 ROAD DESIGN (FROM SEPERATE EA STUDY) TO BE CONSIDERED DURING DETAILED DESIGN.

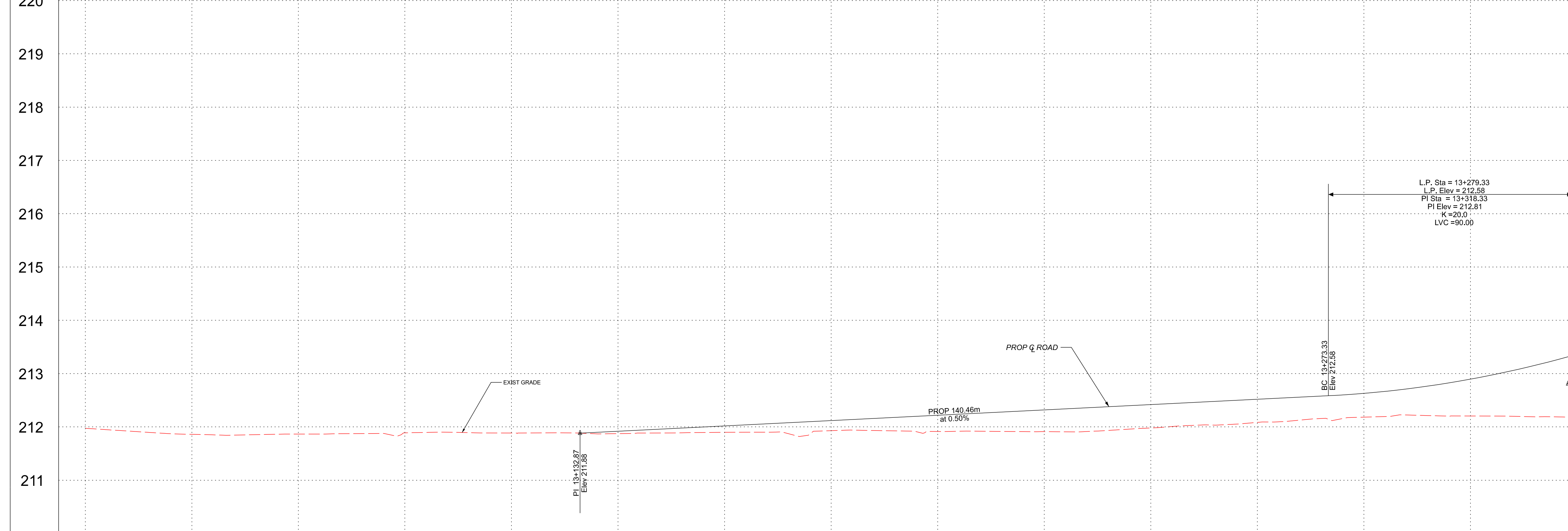

STORM INVERT	SANITARY INVERT	PROPOSED GRADES	CENTERLINE CHAINAGE	STORM INVERT	SANITARY INVERT	PROPOSED GRADES	CENTERLINE CHAINAGE
			13+000				13+000
			13+060				13+060
			13+100				13+100
			13+120				13+120
			13+133 211.08				13+133 211.08
			13+140 211.52				13+140 211.52
			13+160 212.02				13+160 212.02
			13+180 212.12				13+180 212.12
			13+200 212.22				13+200 212.22
			13+220 212.32				13+220 212.32
			13+240 212.42				13+240 212.42
			13+260 212.52				13+260 212.52
			13+273 212.56				13+273 212.56
			13+280 212.63				13+280 212.63
			13+300 212.90				13+300 212.90
			13+320 213.36				13+320 213.36

FOR STORM AND ROADWORKS ONLY

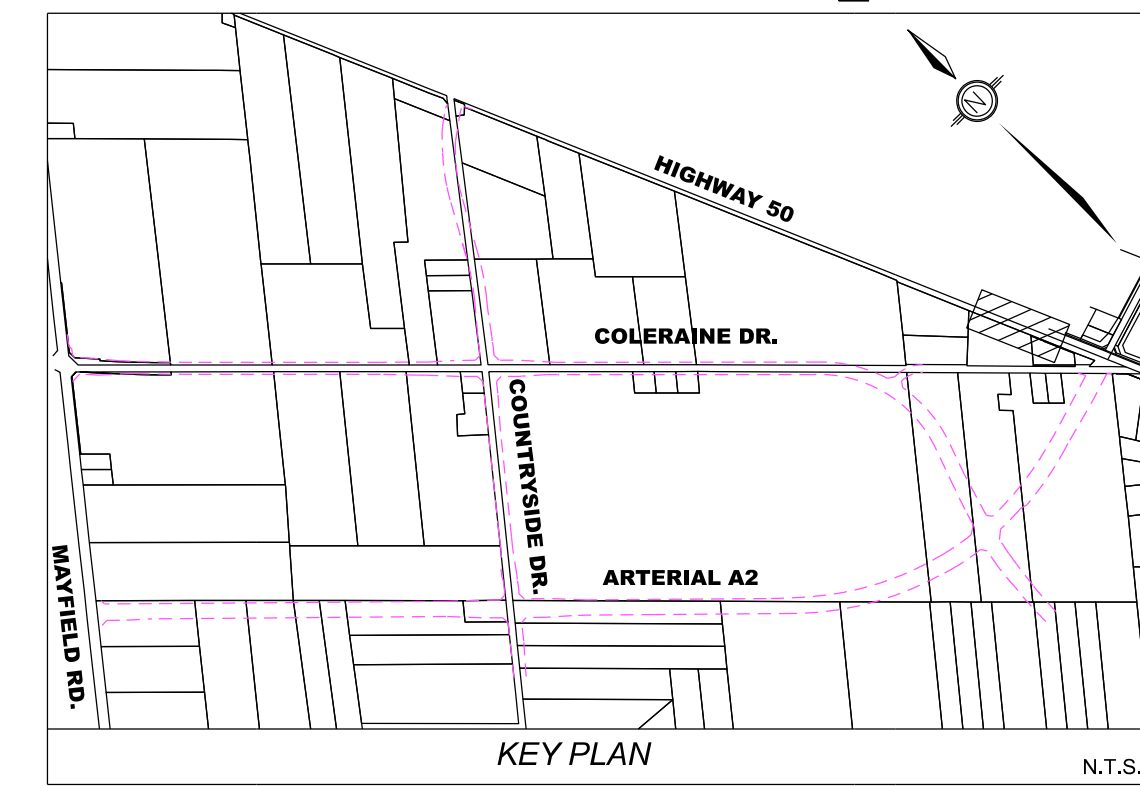

LEGEND:

PROPOSED CONC. BUS BAY	PROPOSED IMPRESSED COLOURED CONC.	PROPOSED SEED / SOD	PROPOSED TEMP ASPH PEDESTRIAN CONNECTION
PROPOSED CONC. KILLSSTRIP/MEDIAN	PROPOSED ASPH MULTI USE TRAIL	PROPOSED IMPRESSED COLOURED CONC.	PROPOSED TEMP ASPH PEDESTRIAN CONNECTION
PROPOSED ASPHALT PAVEMENT	PROPOSED ASPH MULTI USE TRAIL	PROPOSED ASPH MULTI USE TRAIL	PROPOSED SILT FENCE (TREE HOARDING)
PROPOSED DIM REINSTATEMENT	PROPOSED DIM RELOCATED / NEW	PROPOSED DIM RELOCATED / NEW	PROPOSED LIMIT OF GRADING
PROPOSED STORM SEWER (PROFILE ONLY)	PROPOSED STORM SEWER (PROFILE ONLY)	PROPOSED STORM SEWER (PROFILE ONLY)	PROPOSED TEMP ROCK CHECK DAM (DPSD 219.210)
PROPOSED MILLING & PLACEMENT OF 40mm HL1	PROPOSED MILLING & PLACEMENT OF 40mm HL1	PROPOSED MILLING & PLACEMENT OF 40mm HL1	PROPOSED TEMP ROCK CHECK DAM (DPSD 219.210)
PROPOSED CONC. SIDEWALK / BUS PAD	PROPOSED CONC. SIDEWALK / BUS PAD	PROPOSED CONC. SIDEWALK / BUS PAD	PROPOSED TEMP ROCK CHECK DAM (DPSD 219.210)
PROPOSED TACTILE WALKING STRIP INDICATOR	PROPOSED TACTILE WALKING STRIP INDICATOR	PROPOSED TACTILE WALKING STRIP INDICATOR	PROPOSED TEMP ROCK CHECK DAM (DPSD 219.210)
EXIST. SANITARY SEWER	EXIST. SANITARY SEWER	EXIST. SANITARY SEWER	EXIST. OVERHEAD HYDRO
EXIST. WATERMAIN	EXIST. WATERMAIN	EXIST. WATERMAIN	EXIST. BELL
EXIST. GAS	EXIST. GAS	EXIST. GAS	PROPOSED OVERHEAD HYDRO
PROPOSED WATERMAIN	PROPOSED WATERMAIN	PROPOSED WATERMAIN	PROPOSED UNDERGROUND HYDRO
PROPOSED SANITARY SEWER	PROPOSED SANITARY SEWER	PROPOSED SANITARY SEWER	PROPOSED STORM SEWER

- NOTES:**
- ALL EXIST MH TOPS, GAS, WATER & OTHER APPURTENANCES TO BE ADJUSTED TO SUIT PROP GRADES
 - DCB & DICB LEADS TO BE 200mm, CB LEADS TO BE 300mm, UNLESS OTHERWISE NOTED
 - ALL EXISTING CURBS WITHIN P.O.W. TO BE REMOVED UNLESS OTHERWISE NOTED
 - PROPOSED MEDIANS TO HAVE CONCRETE BARRIER CURB O.P.S.D. 600.080
 - PROPOSED CONCRETE KILLSSTRIP / MEDIAN SHALL BE DESIGNED TO 150mm CONCRETE 32MPa 200mm OF 20mm CRUSHER RUN LIMESTONE
 - ALL EXISTING UTILITY LOCATIONS ARE APPROXIMATE AND ARE TO BE CONFIRMED IN THE FIELD PRIOR TO CONSTRUCTION
 - FOR FINAL LAYOUT APPROVAL OF TRANSIT PADS PRIOR TO INSTALLATION, PLEASE CONTACT DAVID STOWE AT (905) 874-2750 EXT 62379 OR CHRIS LAFLEUR EXT 62620
 - CITY REFERS TO THE CITY OF BRAMPTON
 - SEE DRAWINGS - - - FOR DIMENSIONS
 - SEE DRAWINGS - - - FOR REMOVALS
 - SEE DRAWING - - - FOR TYPICAL CROSS SECTIONS
 - SEE DRAWINGS - - - FOR PAVEMENT ELEVATION DETAILS
 - SEE DRAWINGS - - - FOR PAVEMENT MARKINGS AND SIGNAGE
 - SEE DRAWINGS - - - FOR LANDSCAPING DRAWINGS
 - SEE DRAWINGS - - - FOR STRUCTURAL DRAWINGS

REFERENCE: BENCH MARK F2-581 240.393m
One story brick building, on 45 Regan Road. Tablet is set in the southeast face of concrete foundation, 3.25m northeasterly of the southerly building corner and 0.15m above the sidewalk.

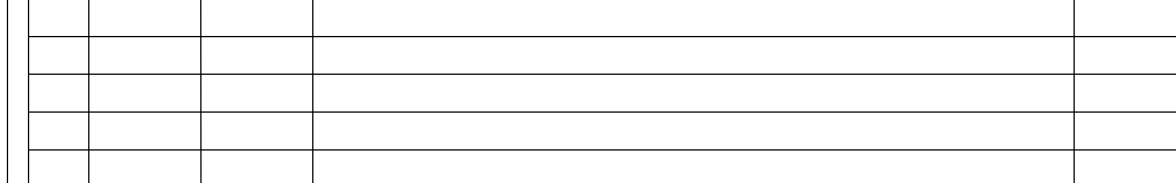

01	M.K.	JULY 27, 2022	ISSUED FOR 30% REVIEW	M.K.
NO.	BY	DATE	REVISIONS	CHECKED

BRAMPTON Flower City
Region of Peel working with you
wood.
Public Works & Engineering
Capital Works

PROJECT	DWG. NO.
---------	----------

HIGHWAY 50
STA. 13+040 TO STA. 13+320
Description

PROPOSED RECONSTRUCTION

SURVEYED BY: BRAMPTON	DATE: JULY 27, 2022	FILE NO.:	xxxxxx
DRAWN BY: D. TUNO	CHECKED BY: M. KHAN	DRAWING NO.:	SHEET NO.
DESIGNED BY: M. KHAN	CHECKED BY: M. KHAN	xx-xx-xx	HWY50-1
SCALE: v 1:50 h 1:500	DATE: JULY 27, 2022		

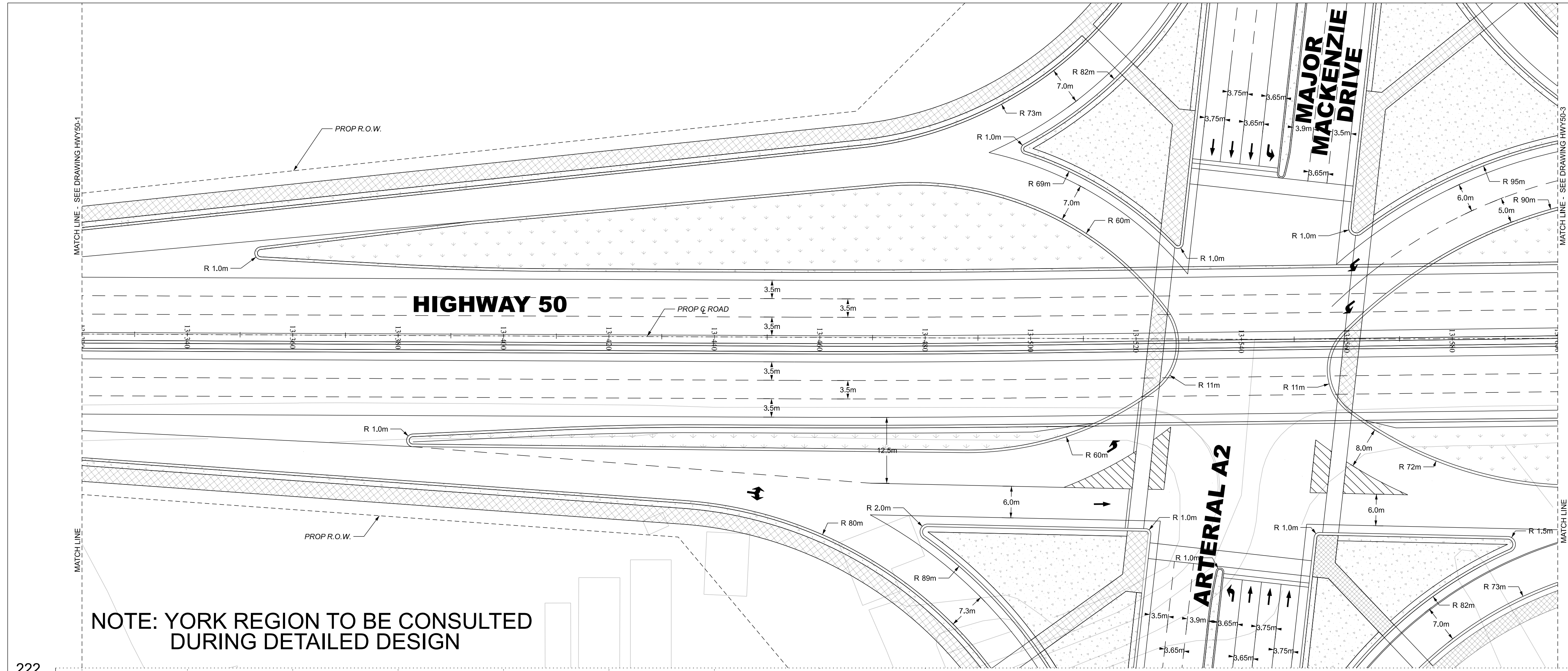

NOTE: YORK REGION TO BE CONSULTED DURING DETAILED DESIGN

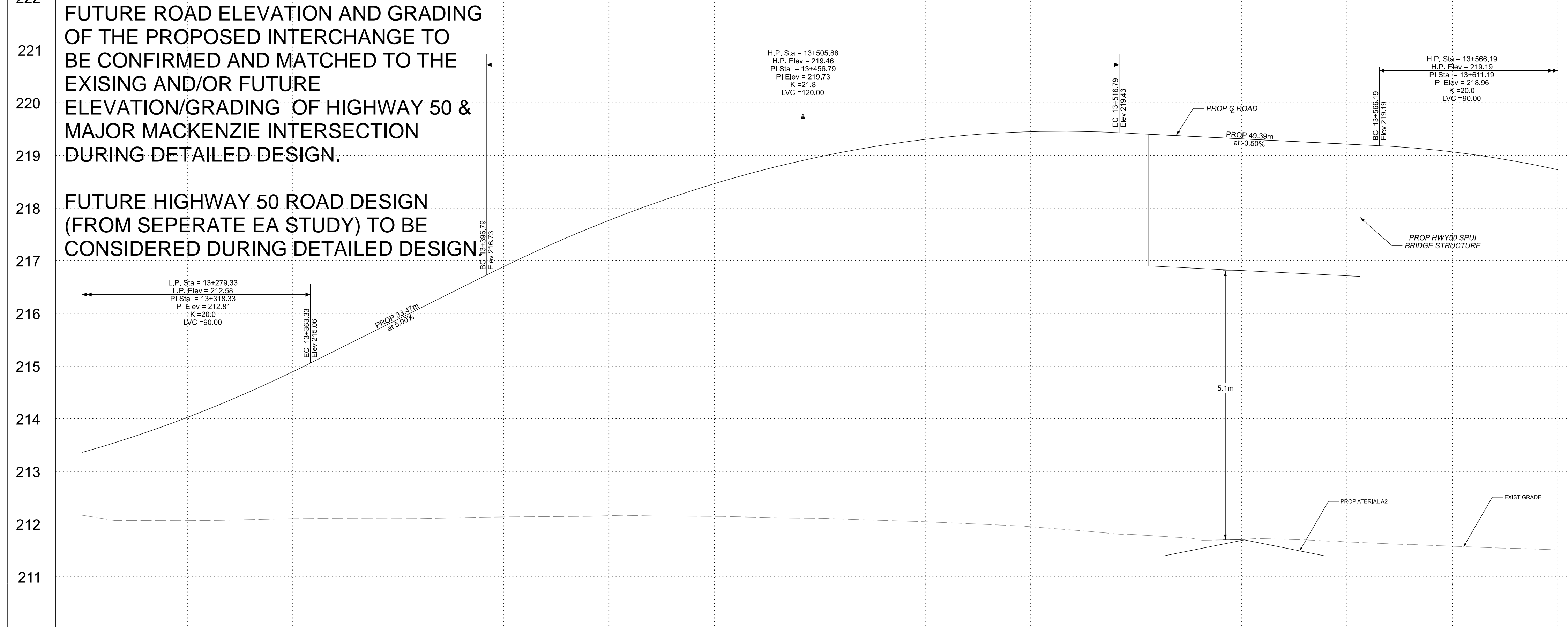

STORM INVERT	SANITARY INVERT	PROPOSED GRADES	CENTERLINE CHAINAGE	STORM INVERT	SANITARY INVERT	PROPOSED GRADES	CENTERLINE CHAINAGE
		13+340 214.03				13+340 214.03	
		13+360 214.90				13+360 214.90	
		13+363 215.06				13+363 215.06	
		13+380 215.89				13+380 215.89	
		13+397 216.73				13+397 216.73	
		13+400 216.89				13+400 216.89	
		13+420 217.77				13+420 217.77	
		13+440 218.47				13+440 218.47	
		13+460 218.88				13+460 218.88	
		13+480 219.31				13+480 219.31	
		13+500 219.45				13+500 219.45	
		13+517 219.43				13+517 219.43	
		13+520 219.42				13+520 219.42	
		13+540 219.32				13+540 219.32	
		13+560 219.22				13+560 219.22	
		13+566 219.19				13+566 219.19	
		13+580 219.07				13+580 219.07	
		13+600 218.73				13+600 218.73	

FOR STORM AND ROADWORKS ONLY

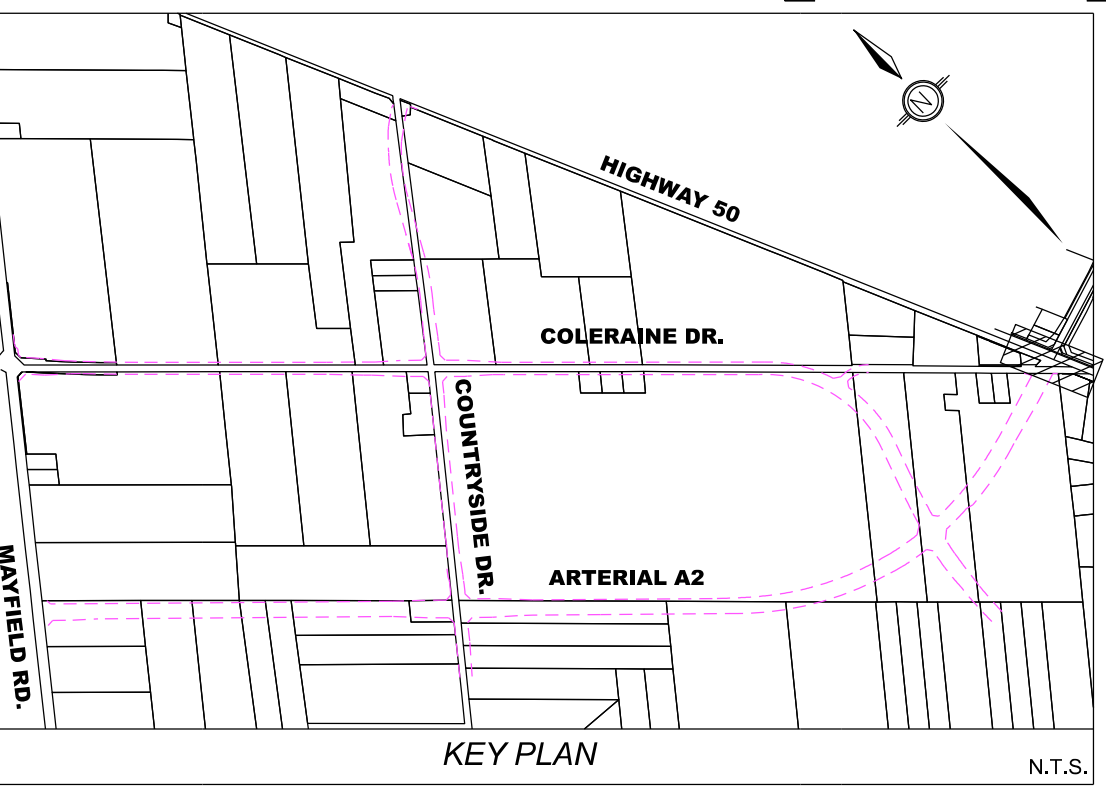

LEGEND:

	PROP CONC BUS BAY		PROP SEED / SOD
	PROP CONC KILLSTRIP/MEDIAN		PROP IMPRESSED COLOURED CONC
	PROP ASPHALT PAVEMENT		PROP ASPH MULTI USE TRAIL
	PROP DW REINSTATEMENT		PROP DW RELOCATED / NEW
	PROP STORM SEWER (PROFILE ONLY)		PROP TEMP ASPH PEDESTRIAN CONNECTION
	PROP MILLING & PLACEMENT OF 40mm H/L		PROP SILT FENCE (TREE HOARDING)
	PROP CONC SIDEWALK / BUS PAD		PROP LIMIT OF GRADING
	PROP TACTILE WALKING STRIP INDICATOR		PROP TEMP ROCK CHECK DAM (RPSD 219.21)
	EX SANITARY SEWER		EX OVERHEAD HYDRO
	EX WATERMAIN		EX BELL
	EX GAS		PROP OVERHEAD HYDRO
	PROP WATERMAIN		PROP UNDERGROUND HYDRO
	PROP SANITARY SEWER		PROP STORM SEWER

- NOTES:**
- ALL EXISTING MH TOPS, GAS, WATER & OTHER APPURTENANCES TO BE ADJUSTED TO SUIT PROP GRADES
 - DCB & DIB LEADS TO BE 200mm, CB LEADS TO BE 200mm UNLESS OTHERWISE NOTED
 - ALL EXISTING CURBS WITHIN R.O.W. TO BE REMOVED UNLESS OTHERWISE NOTED
 - PROPOSED MEDIANS TO HAVE CONCRETE BARRIER CURB O.P.S.D. 600.080
 - PROPOSED CONCRETE KILLSTRIP / MEDIAN SHALL BE DESIGNED TO 150mm CONCRETE 32MPa 200mm OF 20mm CRUSHER RUN LIMESTONE
 - ALL EXISTING UTILITY LOCATIONS ARE APPROXIMATE AND ARE TO BE CONFIRMED IN THE FIELD PRIOR TO CONSTRUCTION
 - FOR FINAL LAYOUT APPROVAL OF TRANSIT PADS PRIOR TO INSTALLATION, PLEASE CONTACT DAVID STOW AT (905) 874-2750 EXT 62379 OR CHRIS LAFLEUR EXT 62620
 - CITY REFERS TO THE CITY OF BRAMPTON
 - SEE DRAWINGS - - - FOR DIMENSIONS
 - SEE DRAWINGS - - - FOR REMOVALS
 - SEE DRAWING - - - FOR TYPICAL CROSS SECTIONS
 - SEE DRAWINGS - - - FOR PAVEMENT ELEVATION DETAILS
 - SEE DRAWINGS - - - FOR PAVEMENT MARKINGS AND SIGNAGE
 - SEE DRAWINGS - - - FOR LANDSCAPING DRAWINGS
 - SEE DRAWINGS - - - FOR STRUCTURAL DRAWINGS
- REFERENCE:** BENCH MARK F2-581 240.393m
One story brick building, on 45 Regan Road. Table is set in the southeast face of corner foundation, 3.25m northeasterly of the southerly building corner and 0.15m above the sidewalk.

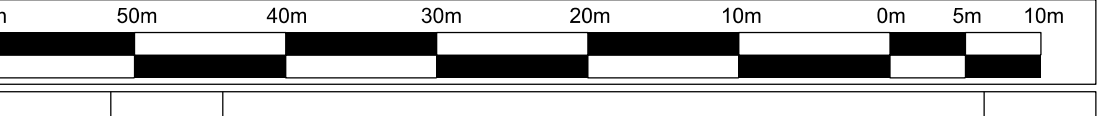

NO.	BY	DATE	REVISIONS	CHECKED
01	M.K.	JULY 27, 2022	ISSUED FOR 30% REVIEW	M.K.

BRAMPTON Flower City
Region of Peel working with you
wood.
 Public Works & Engineering
 Capital Works

PROJECT	DWG. NO.		
---------	----------	--	--

HIGHWAY 50
 STA. 13+320 TO STA. 13+600
 Description
PROPOSED RECONSTRUCTION

SURVEYED BY: BRAMPTON	DATE: JULY 27, 2022	FILE NO.	xxxxxx
DRAWN BY: D. TUNO	CHECKED BY: M. KHAN	DRAWING NO.	
DESIGNED BY: M. KHAN	CHECKED BY: M. KHAN	XX-XX-XX	HWY50-2
SCALE: v 1:50 h 1:500	DATE: JULY 27, 2022		

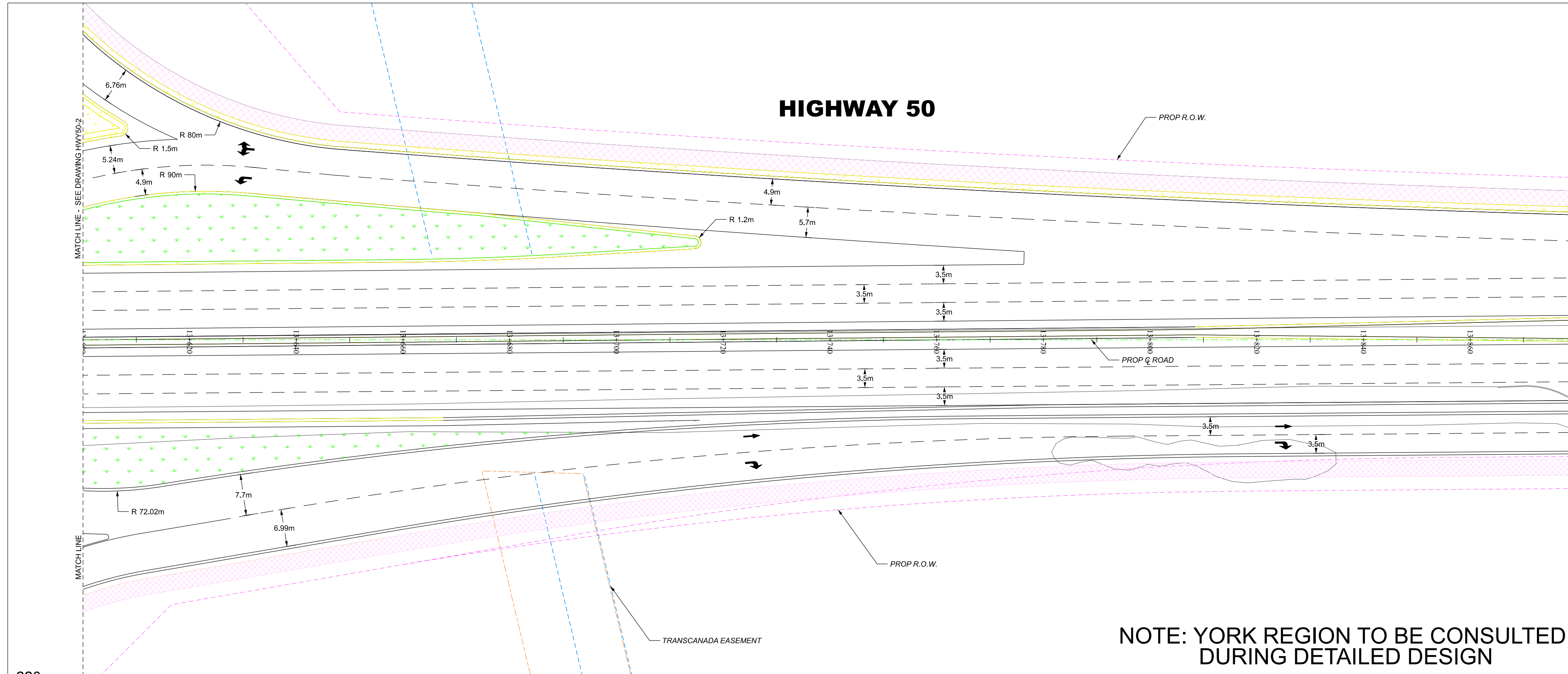

FOR STORM AND ROADWORKS ONLY

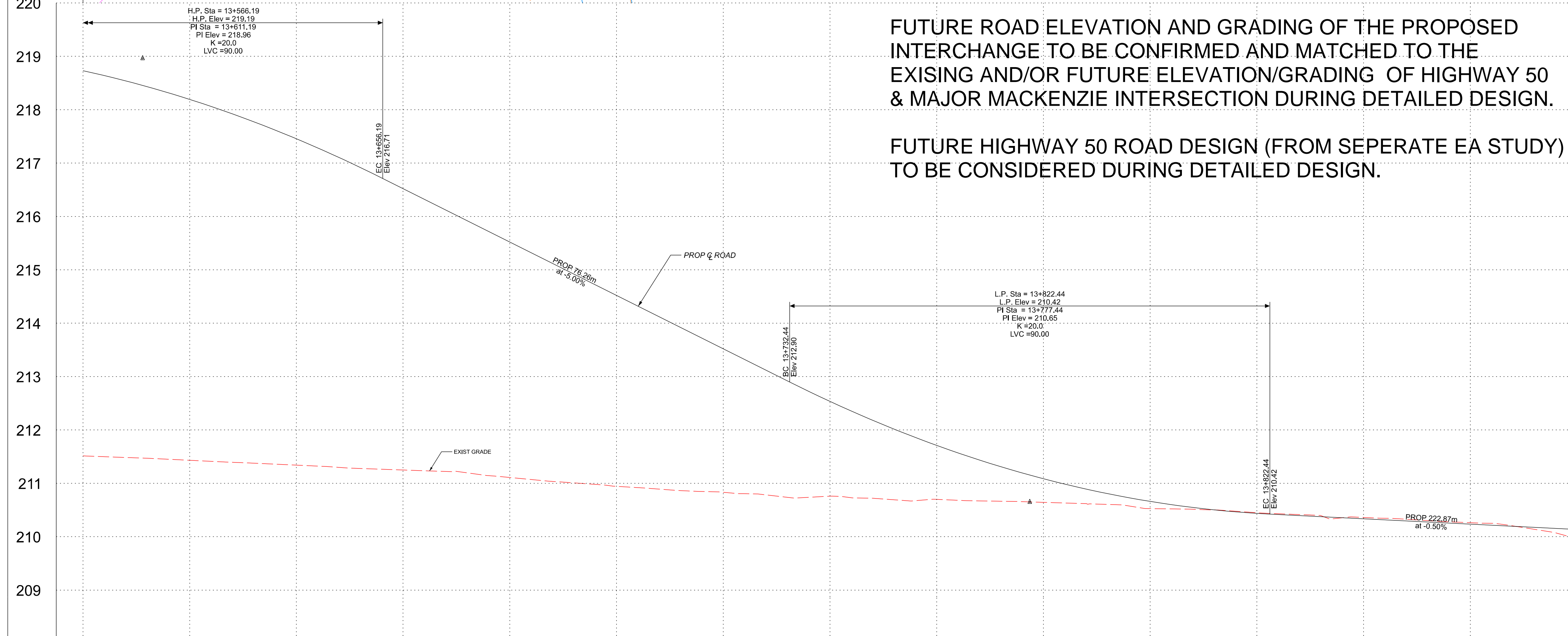
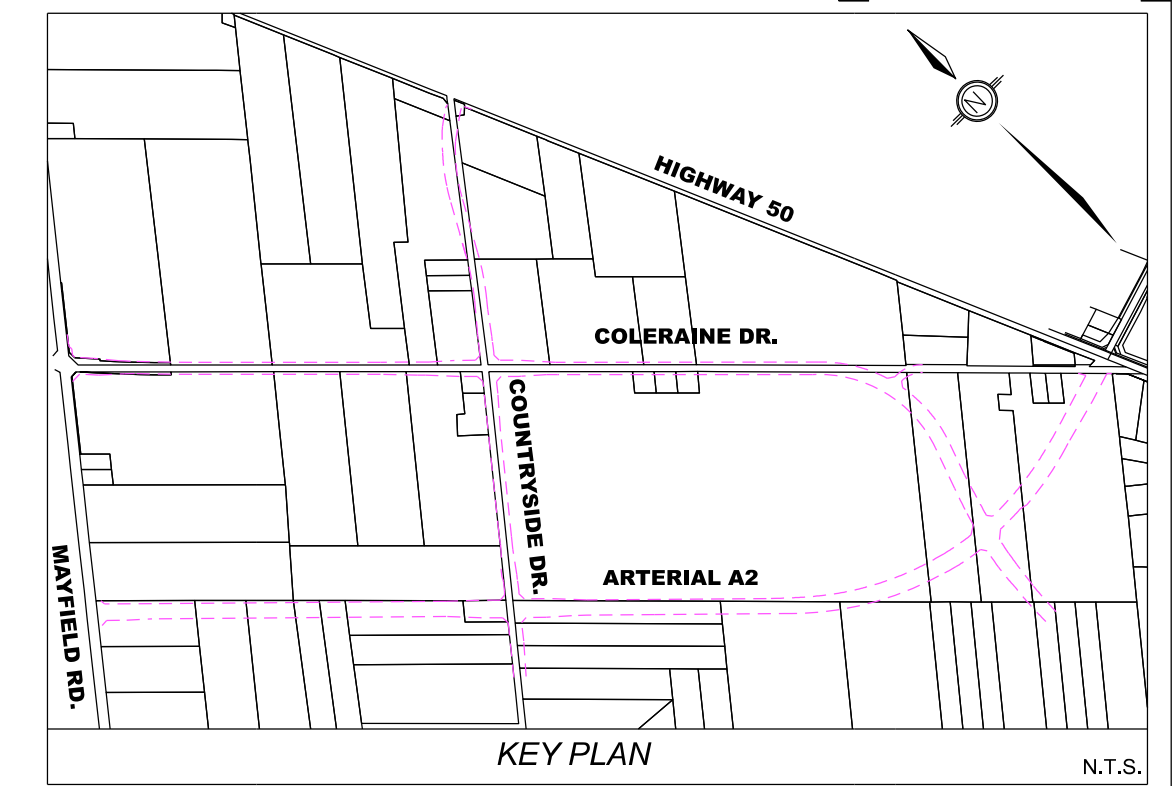

NOTE: YORK REGION TO BE CONSULTED DURING DETAILED DESIGN

FUTURE ROAD ELEVATION AND GRADING OF THE PROPOSED INTERCHANGE TO BE CONFIRMED AND MATCHED TO THE EXISING AND/OR FUTURE ELEVATION/GRADING OF HIGHWAY 50 & MAJOR MACKENZIE INTERSECTION DURING DETAILED DESIGN.

FUTURE HIGHWAY 50 ROAD DESIGN (FROM SEPERATE EA STUDY) TO BE CONSIDERED DURING DETAILED DESIGN.

LEGEND:

PROP CONC BUS BAY	PROP SEED / SOD
PROP CONC KILLS/STRIP/MEDIAN	PROP IMPRESSED COLOURED CONC
PROP ASPHALT PAVEMENT	PROP ASPH MULTI USE TRAIL
PROP DW REINSTATEMENT	PROP DW RELOCATED / NEW
PROP STORM SEWER (PROFILE ONLY)	PROP TEMP ASPH PEDESTRIAN CONNECTION
PROP MILLING & PLACEMENT OF 40mm HLT	PROP SILT FENCE (TREE HOARDINGS)
PROP CONC SIDEWALK / BUS PAD	PROP LIMIT OF GRADING
PROP TACTILE WALKING STRIP INDICATOR	PROP TEMP ROCK CHECK DAM (DPSD 219.210)
EX SANITARY SEWER	EX OVERHEAD HYDRO
EX WATERMAIN	EX BELL
EX GAS	PROP OVERHEAD HYDRO
PROP WATERMAIN	PROP UNDERGROUND HYDRO
PROP SANITARY SEWER	PROP STORM SEWER

- NOTES:**
- ALL EXIST MH TOPS, GAS, WATER & OTHER APPURTENANCES TO BE ADJUSTED TO SUIT PROP GRADES
 - DCB & DIB LEADS TO BE 200mm. CB LEADS TO BE 200mm. UNLESS OTHERWISE NOTED
 - ALL EXISTING CURBS WITHIN P.O.W. TO BE REMOVED UNLESS OTHERWISE NOTED
 - PROPOSED MEDIANS TO HAVE CONCRETE BARRIER CURB O.P.S.D. 600.080
 - PROPOSED CONCRETE KILLS/STRIP / MEDIAN SHALL BE DESIGNED TO 150mm CONCRETE 32MPa 200mm OF 20mm CRUSHER RUN LIMESTONE
 - ALL EXISTING UTILITY LOCATIONS ARE APPROXIMATE AND ARE TO BE CONFIRMED IN THE FIELD PRIOR TO CONSTRUCTION
 - FOR FINAL LAYOUT APPROVAL OF TRANSIT PADS PRIOR TO INSTALLATION, PLEASE CONTACT DAVID STOWE AT (905) 874-2750 EXT 62379 OR CHRIS LAFLEUR EXT 62620
 - CITY REFERS TO THE CITY OF BRAMPTON
 - SEE DRAWINGS - - - FOR DIMENSIONS
 - SEE DRAWINGS - - - FOR REMOVALS
 - SEE DRAWING - - - FOR TYPICAL CROSS SECTIONS
 - SEE DRAWINGS - - - FOR PAVEMENT ELEVATION DETAILS
 - SEE DRAWINGS - - - FOR PAVEMENT MARKINGS AND SIGNAGE
 - SEE DRAWINGS - - - FOR LANDSCAPING DRAWINGS
 - SEE DRAWINGS - - - FOR STRUCTURAL DRAWINGS
- REFERENCE:** **BENCH MARK F2-581 240.393m**
 One story brick building, on 45 Regan Road. Tablet is set in the southeast face of concrete foundation, 3.25m northeasterly of the southerly building corner and 0.15m above the sidewalk.

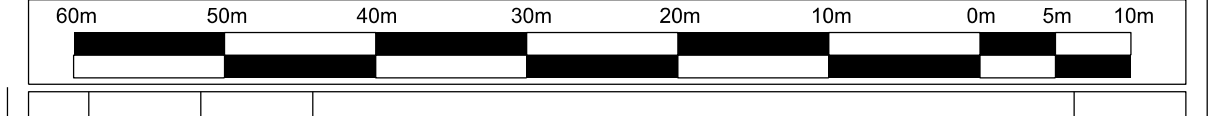

NO.	BY	DATE	REVISIONS	CHECKED
01	M.K.	JULY 27, 2022	ISSUED FOR 30% REVIEW	M.K.

BRAMPTON Flower City
Region of Peel working with you
wood.
 Public Works & Engineering
 Capital Works

STORM INVERT	SANITARY INVERT	PROPOSED GRADES	CENTERLINE CHAINAGE
		13+620 218.19	13+620
		13+650 217.45	13+650
		13+656 216.71	13+656
		13+660 216.52	13+660
		13+680 215.52	13+680
		13+700 214.52	13+700
		13+720 213.52	13+720
		13+732 212.90	13+732
		13+740 212.53	13+740
		13+760 211.71	13+760
		13+780 211.09	13+780
		13+800 210.65	13+800
		13+820 210.44	13+820
		13+822 210.42	13+822
		13+850 210.34	13+850
		13+860 210.24	13+860
		13+880 210.14	13+880

HIGHWAY 50
STA. 13+600 TO STA. 13+880
 Description
PROPOSED RECONSTRUCTION

SURVEYED BY: BRAMPTON	DATE: JULY 27, 2022	FILE NO.:	xxxxxx
DRAWN BY: D. TUNO	CHECKED BY: M. KHAN	DRAWING NO.:	SHEET NO.
DESIGNED BY: M. KHAN	CHECKED BY: M. KHAN	xx-xx-xx	HWY 50-3
SCALE: v 1:50 h 1:500	DATE: JULY 27, 2022		

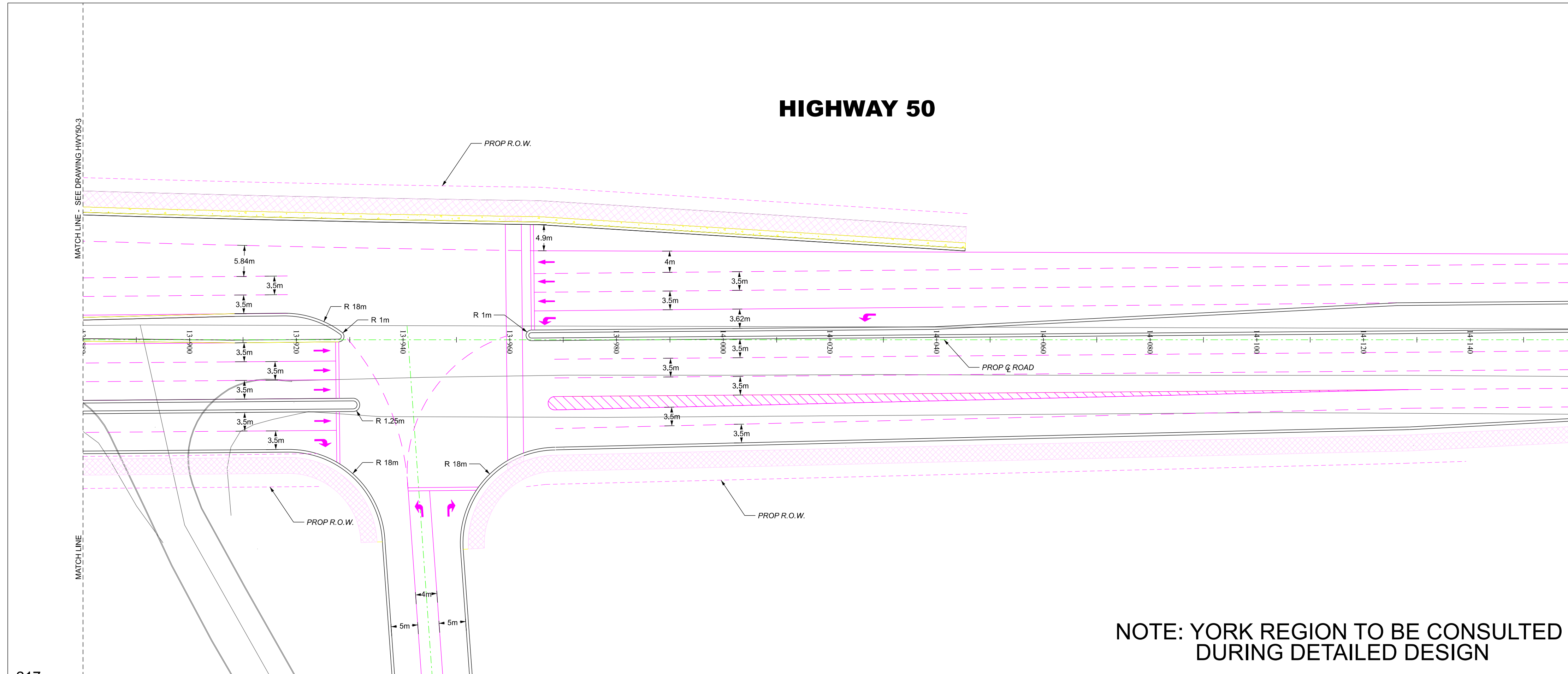

NOTE: YORK REGION TO BE CONSULTED DURING DETAILED DESIGN

FUTURE ROAD ELEVATION AND GRADING OF THE PROPOSED INTERCHANGE TO BE CONFIRMED AND MATCHED TO THE EXISING AND/OR FUTURE ELEVATION/GRADING OF HIGHWAY 50 & MAJOR MACKENZIE INTERSECTION DURING DETAILED DESIGN.

FUTURE HIGHWAY 50 ROAD DESIGN (FROM SEPERATE EA STUDY) TO BE CONSIDERED DURING DETAILED DESIGN.

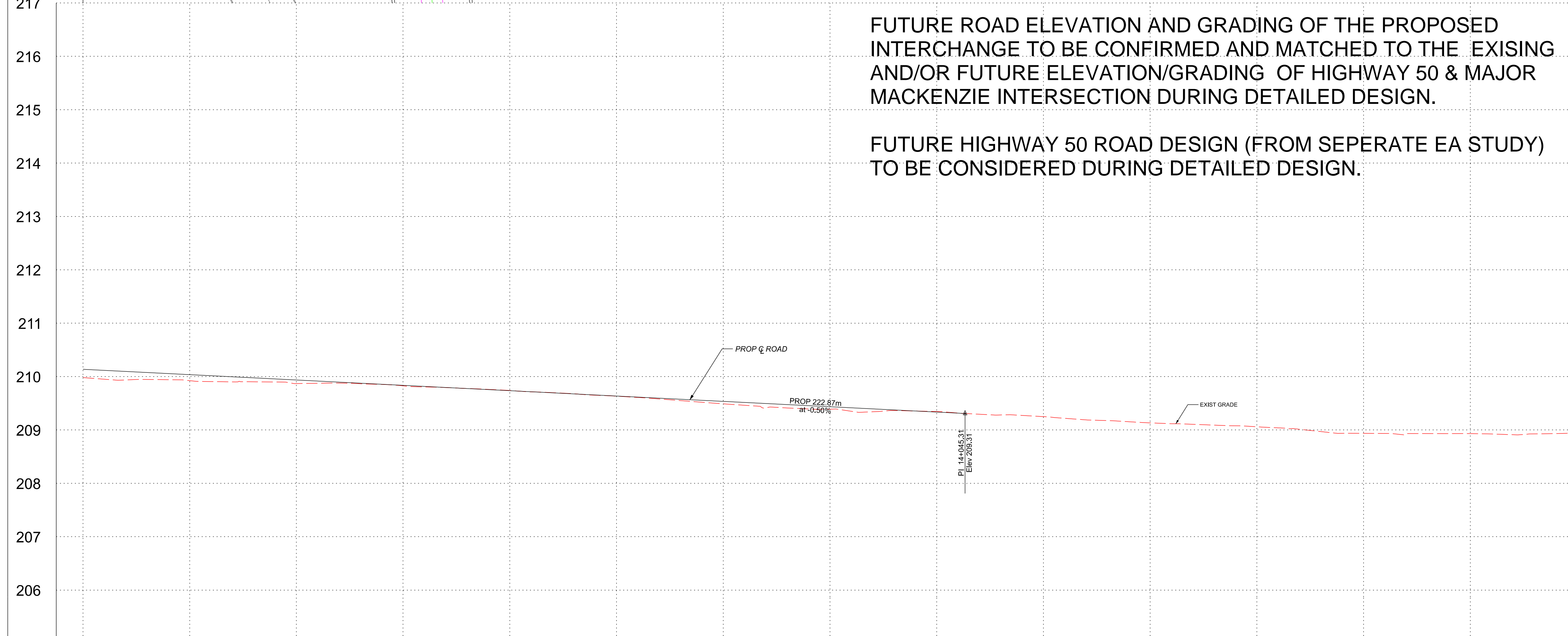

Station	Proposed Grades	Centerline Chirange
13+800	210.04	
13+900	209.94	
13+940	209.84	
13+960	209.74	
13+980	209.64	
14+000	209.54	
14+020	209.44	
14+040	209.34	
14+045	209.31	
14+060	209.21	
14+080	209.11	
14+100	209.01	

FOR STORM AND ROADWORKS ONLY

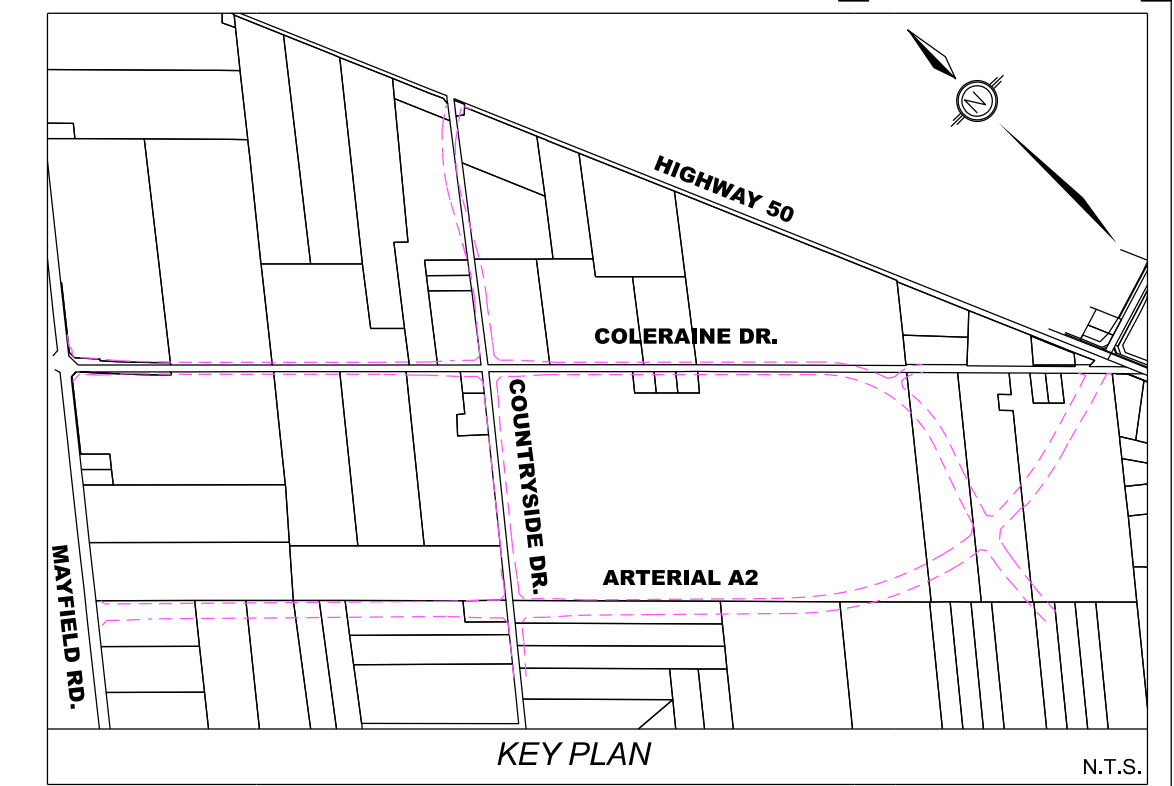

LEGEND:

	PROP CONC BUS BAY		PROP SEED / SOD
	PROP CONC KILLSTRIP/MEDIAN		PROP IMPRESSED COLOURED CONC
	PROP ASPHALT PAVEMENT		PROP ASP MULTI USE TRAIL
	PROP DW REINSTATEMENT		PROP DW RELOCATED / NEW
	PROP STORM SEWER (PROFILE ONLY)		PROP TEMP ASPH PEDESTRIAN CONNECTION
	PROP MILLING & PLACEMENT OF 40mm H1		PROP SILT FENCE (TREE HOARDING)
	PROP CONC SIDEWALK / BUS PAD		PROP LIMIT OF GRADING
	PROP TACTILE WALKING STRIP INDICATOR		PROP TEMP ROCK CHECK DAM (DPSD 219.210)
	EX SANITARY SEWER		EX OVERHEAD HYDRO
	EX WATERMAIN		EX BELL
	EX GAS		PROP OVERHEAD HYDRO
	PROP WATERMAIN		PROP UNDERGROUND HYDRO
	PROP SANITARY SEWER		PROP STORM SEWER

- NOTES:**
- ALL EXIST MH TOPS, GAS, WATER & OTHER APPURTENANCES TO BE ADJUSTED TO SUIT PROP GRADES
 - DCB & DIB LEADS TO BE 200mm. CB LEADS TO BE 200mm. UNLESS OTHERWISE NOTED
 - ALL EXISTING CURBS WITHIN R.O.W. TO BE REMOVED UNLESS OTHERWISE NOTED
 - PROPOSED MEDIANS TO HAVE CONCRETE BARRIER CURB O.P.S.D. 600.080
 - PROPOSED CONCRETE KILLSTRIP / MEDIAN SHALL BE DESIGNED TO 150mm CONCRETE 32MPa 200mm OF 20mm CRUSHER RUN LIMESTONE
 - ALL EXISTING UTILITY LOCATIONS ARE APPROXIMATE AND ARE TO BE CONFIRMED IN THE FIELD PRIOR TO CONSTRUCTION
 - FOR FINAL LAYOUT APPROVAL OF TRANSIT PADS PRIOR TO INSTALLATION, PLEASE CONTACT DAVID STOWE AT (905) 874-2750 EXT 62379 OR CHRIS LAFLEUR EXT 62620
 - CITY REFERS TO THE CITY OF BRAMPTON
 - SEE DRAWINGS - - - FOR DIMENSIONS
 - SEE DRAWINGS - - - FOR REMOVALS
 - SEE DRAWING - - - FOR TYPICAL CROSS SECTIONS
 - SEE DRAWINGS - - - FOR PAVEMENT ELEVATION DETAILS
 - SEE DRAWINGS - - - FOR PAVEMENT MARKINGS AND SIGNAGE
 - SEE DRAWINGS - - - FOR LANDSCAPING DRAWINGS
 - SEE DRAWINGS - - - FOR STRUCTURAL DRAWINGS
- REFERENCE:** **BENCH MARK F2-581 240.393m**
 One story brick building, no. 45 Regan Road. Tablet is set in the southeast face of concrete foundation, 3.25m northeasterly of the southerly building corner and 0.15m above the sidewalk.

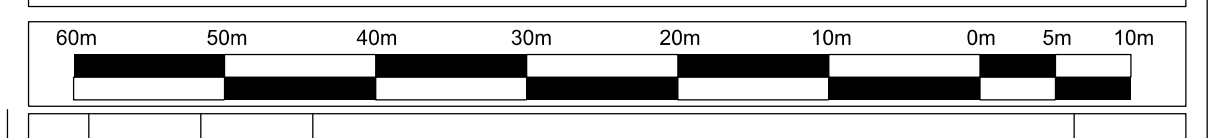

NO.	BY	DATE	REVISIONS	CHECKED
01	M.K.	JULY 27, 2022	ISSUED FOR 30% REVIEW	M.K.

BRAMPTON Flower City
Region of Peel working with you
wood.
 Public Works & Engineering
 Capital Works

PROJECT	DWG. NO.
---------	----------

HIGHWAY 50
STA. 13+880 TO STA. 14+160
 Description
PROPOSED RECONSTRUCTION

SURVEYED BY: BRAMPTON	DATE: JULY 27, 2022	FILE NO.	xxxxxx
DRAWN BY: D. TUNO	CHECKED BY: M. KHAN	DRAWING NO.	SHEET NO.
DESIGNED BY: M. KHAN	CHECKED BY: M. KHAN	xx-xx-xx	HWY50-4
SCALE: v 1:50 h 1:500	DATE: JULY 27, 2022		

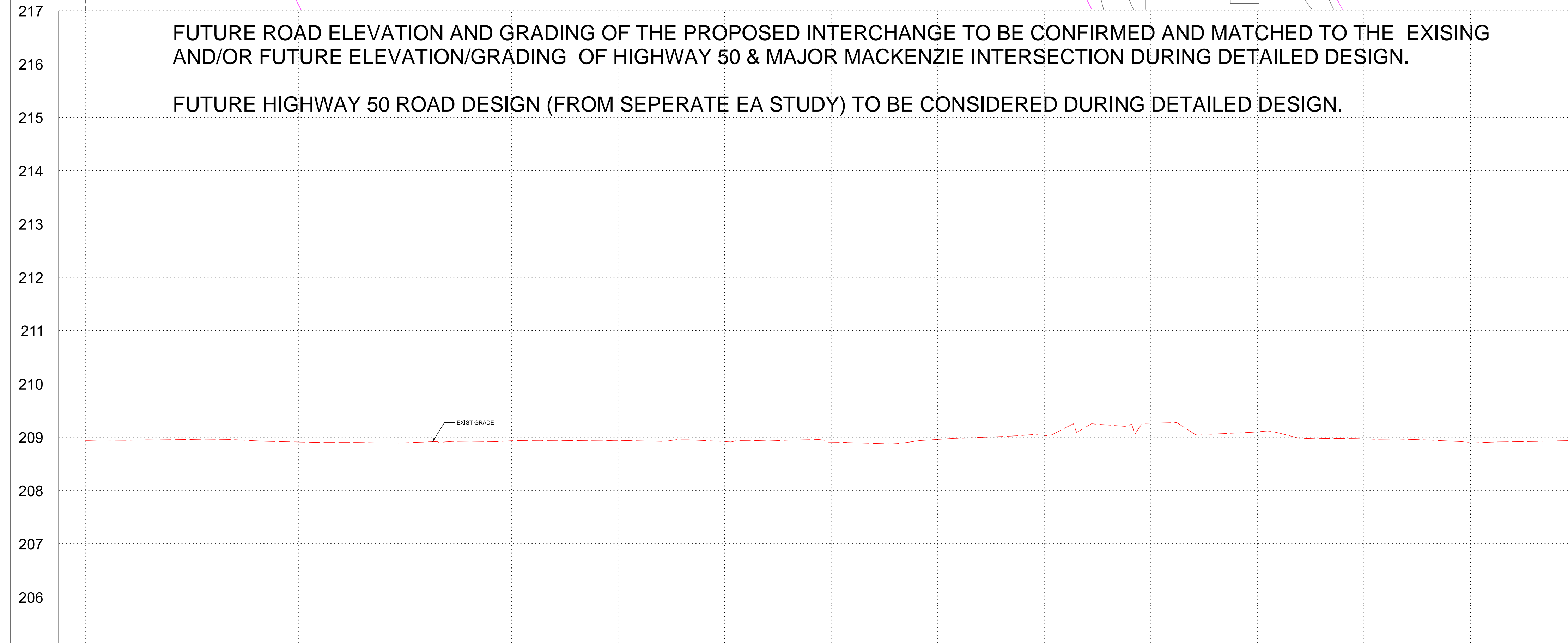
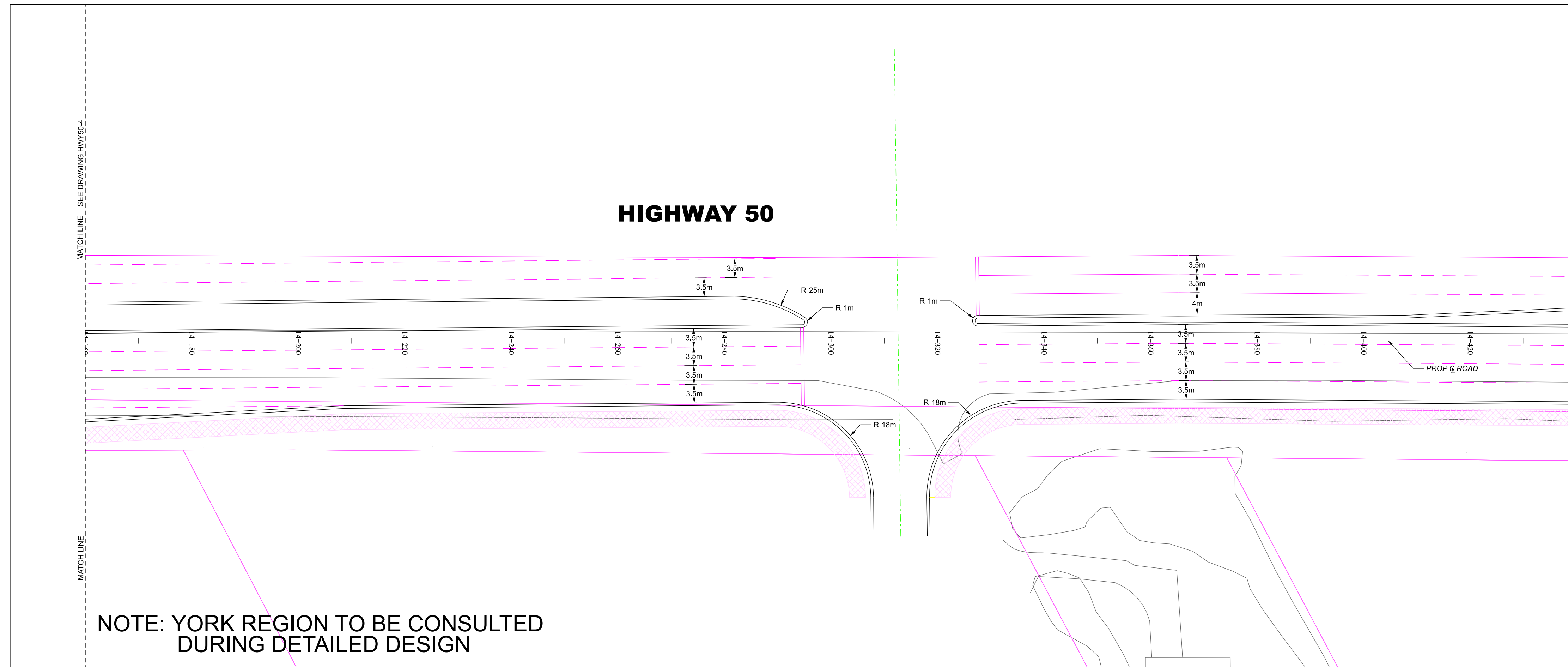

FOR STORM AND ROADWORKS ONLY

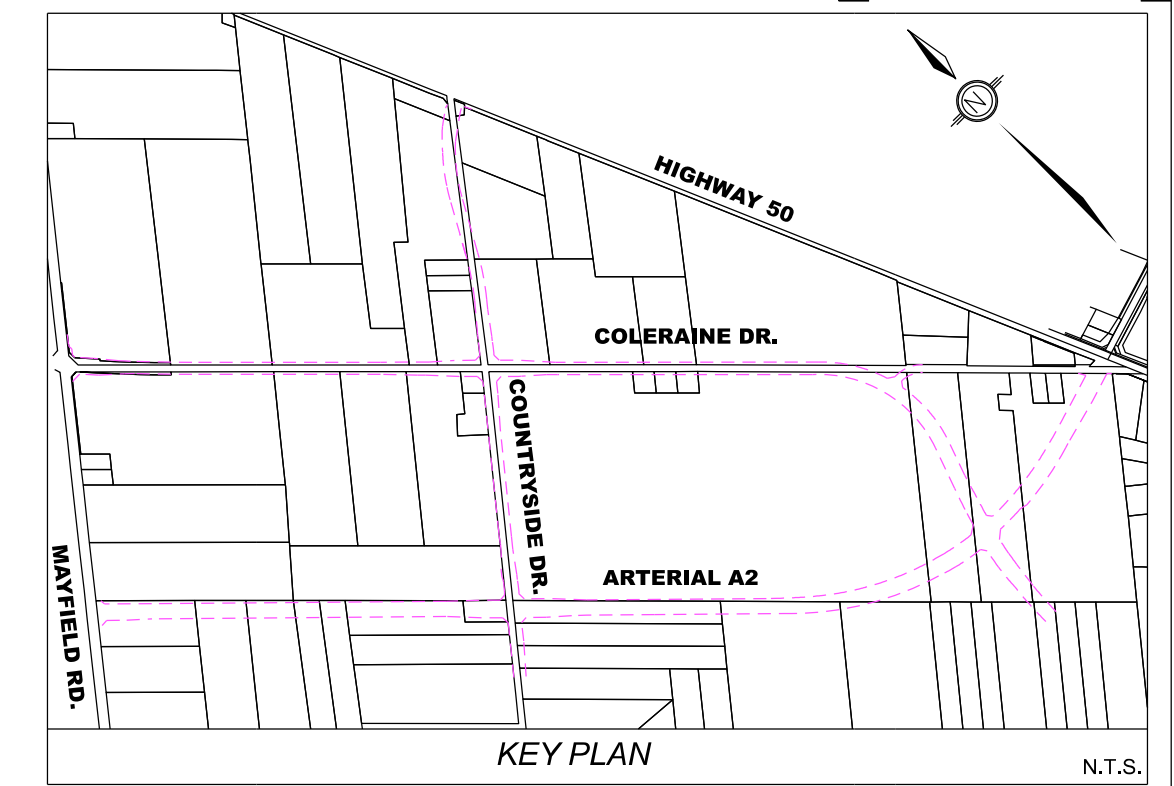

LEGEND:

	PROP CONC BUS BAY		PROP SEED / SOD
	PROP CONC KILL STRIP / MEDIAN		PROP IMPRESSED COLOURED CONC
	PROP ASPHALT PAVEMENT		PROP ASPH MULTI USE TRAIL
	PROP DW REINSTATEMENT		PROP DW RELOCATED / NEW
	PROP STORM SEWER (PROFILE ONLY)		PROP TEMP ASPH PEDESTRIAN CONNECTION
	PROP MILLING & PLACEMENT OF 40mm H1		PROP SILT FENCE (TREE HOARDINGS)
	PROP CONC SIDEWALK / BUS PAD		PROP LIMIT OF GRADING
	PROP TACTILE WALKING STRIP INDICATOR		PROP TEMP ROCK CHECK DAM (DPSD 219.210)
	EX SANITARY SEWER		EX OVERHEAD HYDRO
	EX WATERMAIN		EX BELL
	EX GAS		PROP OVERHEAD HYDRO
	PROP WATERMAIN		PROP UNDERGROUND HYDRO
	PROP SANITARY SEWER		PROP STORM SEWER

- NOTES:**
- ALL EXIST MH TOPS, GAS, WATER & OTHER APPURTENANCES TO BE ADJUSTED TO SUIT PROP GRADES
 - DCB & DCB LEADS TO BE 200mm. CB LEADS TO BE 200mm. UNLESS OTHERWISE NOTED
 - ALL EXISTING CURBS WITHIN F.O.W. TO BE REMOVED UNLESS OTHERWISE NOTED
 - PROPOSED MEDIANS TO HAVE CONCRETE BARRIER CURB O.P.S.D. 600.080
 - PROPOSED CONCRETE KILL STRIP / MEDIAN SHALL BE DESIGNED TO 150mm CONCRETE 32MPa 200mm OF 20mm CRUSHER RUN LIMESTONE
 - ALL EXISTING UTILITY LOCATIONS ARE APPROXIMATE AND ARE TO BE CONFIRMED IN THE FIELD PRIOR TO CONSTRUCTION
 - FOR FINAL LAYOUT APPROVAL OF TRANSIT PADS PRIOR TO INSTALLATION, PLEASE CONTACT DAVID STOWE AT (905) 874-2750 EXT 62373 OR CHRIS LAFLEUR EXT 62620
 - CITY REFERS TO THE CITY OF BRAMPTON
 - SEE DRAWINGS - - - FOR DIMENSIONS
 - SEE DRAWINGS - - - FOR REMOVALS
 - SEE DRAWING - - - FOR TYPICAL CROSS SECTIONS
 - SEE DRAWINGS - - - FOR PAVEMENT ELEVATION DETAILS
 - SEE DRAWINGS - - - FOR PAVEMENT MARKINGS AND SIGNAGE
 - SEE DRAWINGS - - - FOR LANDSCAPING DRAWINGS
 - SEE DRAWINGS - - - FOR STRUCTURAL DRAWINGS

REFERENCE: **BENCHMARK F2-581 240.393m**
 One story brick building, on 45 Regan Road. Tablet is set in the southeast face of concrete foundation, 3.25m northeasterly of the southerly building corner and 0.15m above the sidewalk.

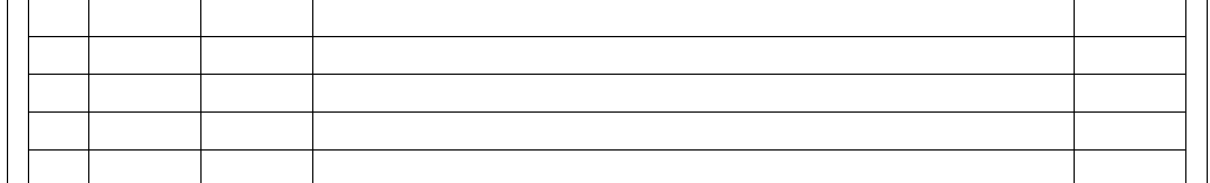

01	M.K.	JULY 27, 2022	ISSUED FOR 30% REVIEW	M.K.
NO.	BY	DATE	REVISIONS	CHECKED

BRAMPTON Flower City

Region of Peel working with you

wood.

Public Works & Engineering
Capital Works

PROJECT DWG. NO.

STORM INVERT																			
SANITARY INVERT																			
PROPOSED GRADES																			
CENTERLINE CHAINAGE	14+160	14+180	14+200	14+220	14+240	14+260	14+280	14+300	14+320	14+340	14+360	14+380	14+400	14+420	14+440				

HIGHWAY 50
 STA. 14+160 TO STA. 14+440

Description

PROPOSED RECONSTRUCTION

SURVEYED BY: BRAMPTON	DATE: JULY 27, 2022	FILE NO.	xxxxxx
DRAWN BY: D. TUNO	CHECKED BY: M. KHAN	DRAWING NO.	
DESIGNED BY: M. KHAN	CHECKED BY: M. KHAN	DATE: JULY 27, 2022	
SCALE: v 1:50 h 1:500			

xx-xx-xx HWY50-5

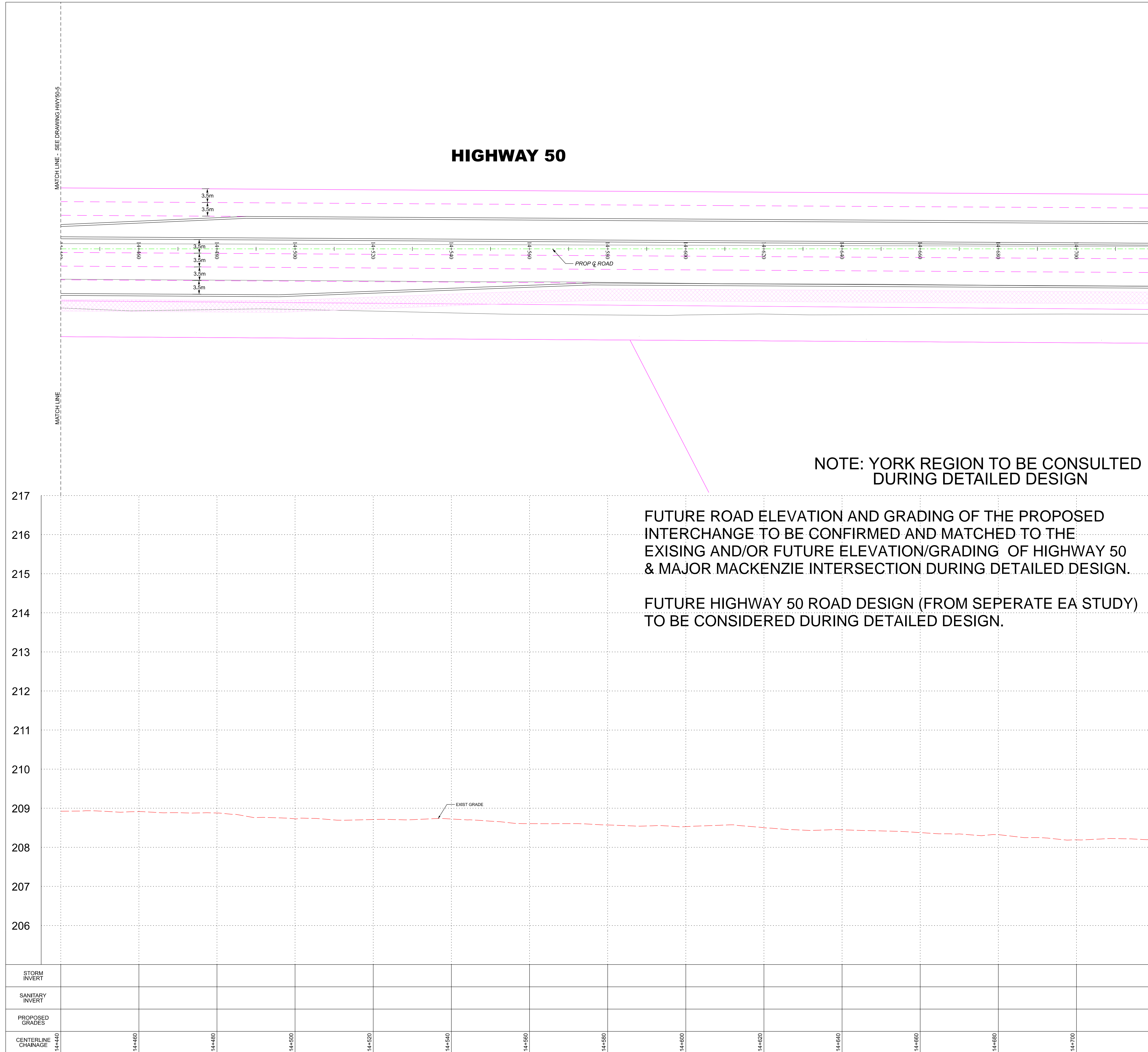

FOR STORM AND ROADWORKS ONLY

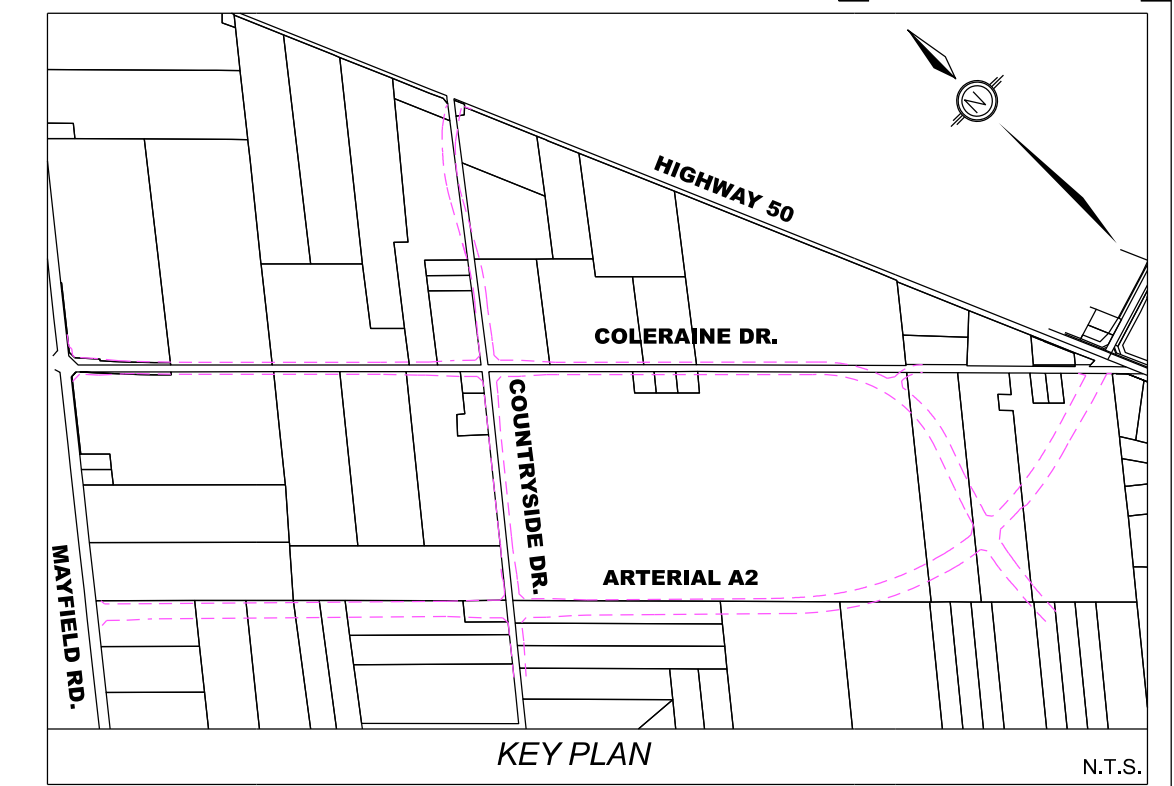

LEGEND:

	PROP CONC BUS BAY		PROP SEED / SOD
	PROP CONC KILL STRIP/MEDIAN		PROP IMPRESSED COLOURED CONC
	PROP ASPHALT PAVEMENT		PROP ASPH MULTI USE TRAIL
	PROP DW REINSTATEMENT		PROP DW RELOCATED / NEW
	PROP STORM SEWER (PROFILE ONLY)		PROP TEMP ASPH PEDESTRIAN CONNECTION
	PROP MILLING & PLACEMENT OF 40mm HLT		PROP SILT FENCE (TREE HOARDING)
	PROP CONC SIDEWALK / BUS PAD		PROP LIMIT OF GRADING
	PROP TACTILE WALKING STRIP INDICATOR		PROP TEMP ROCK CHECK DAM (DPSD 219.210)
	EX SANITARY SEWER		EX OVERHEAD HYDRO
	EX WATERMAIN		EX BELL
	EX GAS		PROP OVERHEAD HYDRO
	PROP WATERMAIN		PROP UNDERGROUND HYDRO
	PROP SANITARY SEWER		PROP STORM SEWER

- NOTES:**
- ALL EXIST MH TOPS, GAS, WATER & OTHER APPURTENANCES TO BE ADJUSTED TO SUIT PROP GRADES
 - DCB & DIB LEADS TO BE 200mm, CB LEADS TO BE 200mm, UNLESS OTHERWISE NOTED
 - ALL EXISTING CURBS WITHIN F.O.W. TO BE REMOVED UNLESS OTHERWISE NOTED
 - PROPOSED MEDIANS TO HAVE CONCRETE BARRIER CURB O.P.S.D. 600.080
 - PROPOSED CONCRETE KILL STRIP / MEDIAN SHALL BE DESIGNED TO 150mm CONCRETE 32MPa 200mm OF 20mm CRUSHER RUN LIMESTONE
 - ALL EXISTING UTILITY LOCATIONS ARE APPROXIMATE AND ARE TO BE CONFIRMED IN THE FIELD PRIOR TO CONSTRUCTION
 - FOR FINAL LAYOUT APPROVAL OF TRANSIT PADS PRIOR TO INSTALLATION, PLEASE CONTACT DAVID STOWE AT (905) 874-2750 EXT 62379 OR CHRIS LAFLEUR EXT 62620
 - CITY REFERS TO THE CITY OF BRAMPTON
 - SEE DRAWINGS - - - FOR DIMENSIONS
 - SEE DRAWINGS - - - FOR REMOVALS
 - SEE DRAWING - - - FOR TYPICAL CROSS SECTIONS
 - SEE DRAWINGS - - - FOR PAVEMENT ELEVATION DETAILS
 - SEE DRAWINGS - - - FOR PAVEMENT MARKINGS AND SIGNAGE
 - SEE DRAWINGS - - - FOR LANDSCAPING DRAWINGS
 - SEE DRAWINGS - - - FOR STRUCTURAL DRAWINGS
- REFERENCE:** **BENCH MARK F2-581 240.393m**
One story brick building, on 45 Regan Road. Tablet is set in the southeast face of concrete foundation, 3.25m northeasterly of the southerly building corner and 0.15m above the sidewalk.

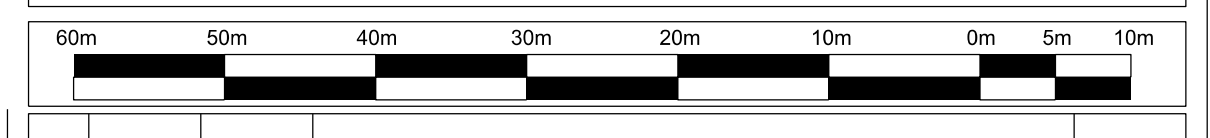

NO.	BY	DATE	REVISIONS	CHECKED
01	M.K.	JULY 27, 2022	ISSUED FOR 30% REVIEW	M.K.

Public Works & Engineering
Capital Works

working with you

HIGHWAY 50			
STA. 14+440 TO STA. 14+720			
Description			
PROPOSED RECONSTRUCTION			
SURVEYED BY: BRAMPTON	DATE: JULY 27, 2022	FILE NO.	xxxxxx
DRAWN BY: D. TUNO	CHECKED BY: M. KHAN	DRAWING NO.	SHEET NO.
DESIGNED BY: M. KHAN	CHECKED BY: M. KHAN	xx-xx-xx	HWY50-6
SCALE: v 1:50 h 1:500	DATE: JULY 27, 2022		