

Permit Application Requirements – New Plumbing Fixtures

Required Documents & Plans

The following information is required at submission. Incomplete applications **cannot** be accepted

1. Completed building permit application consisting of:
 - ☐ Application form “Permit to Construct or Demolish” (No longer required. Will be part of your Brampton Portal submission)
 - ☐ Schedule 1: Designer Information
 - ☐ Applicable Law Check List
2. Set of plans drawn to scale which must include:
 - ☐ Plan Drawings
 - Provide a plan view of the existing layout for the floor area in which you propose to install the new plumbing fixtures.
 - Illustrate the proposed location of the new plumbing fixtures and label each new fixture (I.e. new sink, new laundry tub, new shower etc. – see sample drawing)
3. Permit fee of \$316.71 applies to our **Standard 10 Day Permit Application Service**

Building Permit Issuance

1. Where a permit is to be issued to for construction within a common element of a registered condominium a Notice of Permission to Construct form, signed by an authorized agent of the condominium corporation, shall be submitted for the authorization of work to be undertaken within the common element of the building or property.

Schedule 1: Designer Information

Use one form for each individual who reviews and takes responsibility for design activities with respect to the project.

A. Project Information			
Building number, street name		Unit no.	Lot/con.
Municipality	Postal code	Plan number/ other description	
B. Individual who reviews and takes responsibility for design activities			
Name		Firm	
Street address		Unit no.	Lot/con.
Municipality	Postal code	Province	E-mail
Telephone number	Fax number	Cell number	
C. Design activities undertaken by individual identified in Section B. [Building Code Table 3.5.2.1. of Division C]			
<div style="display: flex; flex-wrap: wrap;"> <div style="width: 33%;"><input type="checkbox"/> House</div> <div style="width: 33%;"><input type="checkbox"/> HVAC – House</div> <div style="width: 33%;"><input type="checkbox"/> Building Structural</div> <div style="width: 33%;"><input type="checkbox"/> Small Buildings</div> <div style="width: 33%;"><input type="checkbox"/> Building Services</div> <div style="width: 33%;"><input type="checkbox"/> Plumbing – House</div> <div style="width: 33%;"><input type="checkbox"/> Large Buildings</div> <div style="width: 33%;"><input type="checkbox"/> Detection, Lighting and Power</div> <div style="width: 33%;"><input type="checkbox"/> Plumbing – All Buildings</div> <div style="width: 33%;"><input type="checkbox"/> Complex Buildings</div> <div style="width: 33%;"><input type="checkbox"/> Fire Protection</div> <div style="width: 33%;"><input type="checkbox"/> On-site Sewage Systems</div> </div>			
Description of designer's work			
D. Declaration of Designer			
<p>I _____ declare that (choose one as appropriate):</p> <p style="text-align: center;">(print name)</p> <p><input type="checkbox"/> I review and take responsibility for the design work on behalf of a firm registered under subsection 3.2.4. of Division C, of the Building Code. I am qualified, and the firm is registered, in the appropriate classes/categories.</p> <p style="margin-left: 40px;">Individual BCIN: _____</p> <p style="margin-left: 40px;">Firm BCIN: _____</p> <p><input type="checkbox"/> I review and take responsibility for the design and am qualified in the appropriate category as an "other designer" under subsection 3.2.5. of Division C, of the Building Code.</p> <p style="margin-left: 40px;">Individual BCIN: _____</p> <p style="margin-left: 40px;">Basis for exemption from registration: _____</p> <p><input type="checkbox"/> The design work is exempt from the registration and qualification requirements of the Building Code.</p> <p style="margin-left: 40px;">Basis for exemption from registration and qualification: _____</p> <p>I certify that:</p> <ol style="list-style-type: none"> The information contained in this schedule is true to the best of my knowledge. I have submitted this application with the knowledge and consent of the firm. <div style="display: flex; justify-content: space-between; margin-top: 20px;"> <div style="width: 30%;"> <p>_____</p> <p>Date</p> </div> <div style="width: 60%;"> <p>_____</p> <p>Signature of Designer</p> </div> </div>			

NOTE:

- For the purposes of this form, "individual" means the "person" referred to in Clause 3.2.4.7(1) (c) of Division C, Article 3.2.5.1. of Division C, and all other persons who are exempt from qualification under Subsections 3.2.4. and 3.2.5. of Division C.
- Schedule 1 is not required to be completed by a holder of a license, temporary license, or a certificate of practice, issued by the Ontario Association of Architects. Schedule 1 is also not required to be completed by a holder of a license to practise, a limited license to practise, or a certificate of authorization, issued by the Association of Professional Engineers of Ontario.

CITY OF BRAMPTON - BUILDING DIVISION

SECTION G. DOCUMENTS ESTABLISHING COMPLIANCE WITH APPLICABLE LAW (OBC Div. A - 1.4.1.3.)

Permit Application No. _____	Project Location _____ # _____ street _____ unit/suite _____
-------------------------------------	---

Explanation:
Applicable Law - Applicable law is other regulations for which approval must be obtained before a building permit can issue. A complete list of Acts and Regulations that are "Applicable Law" is set out in Article 1.4.1.3 of Division A of the Ontario Building Code.

Instructions:
The most common Acts and Regulations are listed below with the documentation that must be provided before a building permit can issue. Check those that apply to your permit application and complete the declaration. The customer service plans examiner will assist you with any questions you may have about the regulations listed. The documents noted must be provided before a building permit can issue.

Details and Contact Information
A list of agencies and contact information is available at the Building Division or on the City of Brampton website

APPLICABLE LAWS (Note: This list provides only the most common approvals)

ACT	Description	REQUIRED DOCUMENTS (Provide copy)	Required Yes/No	Received
Planning Act s.41	(Site Plan Control)	Site plan approved drawings		
Planning Act s.34	(Zoning By-law)	Final & binding amendment		
Planning Act Pt. V1	(Division of Land)	Registered Plan or Deed		
Planning Act s.45	(Minor Variance)	Final Decision from City Clerk		
Planning Act s.33	(Demolition of Residential Property)	Council Approval		
Ontario Heritage Act ss.27 (3), 30(2), 33, ss.34.40.1 & 40.2		Heritage Permit		
Ontario Heritage Act s.34.5 and s. 34.7.(2)		Ministry of Culture approval		
Development Charges Act s.28 and s.53, Education Act s.257.83 & 257.93	(Financial Contribution)	Confirmation of payment from City of Brampton Finance Department		
Planning Act s.42(6)	(Cash in Lieu of Parkland)	Confirmation of payment from City of Brampton Finance Department		
Conservation Authorities Act	(Flood plain or fill regulated area)	Construction and Fill Permit		
Day Nurseries Act, Reg. 262 s.5	(Daycare centre with more than 5 children)	Approval from Ministry of Children and Youth Services		
Education Act s.194	(Demolition of all or part of a school)	Approval from Ministry of Education		
Environmental Protection Act s.168.3.1 & 168.6(1) change of use of land	(Industrial or commercial to agricultural, residential or park)	File Record of Site Condition (RSC) and/or provide Certification of Property use (CPU)		
Public Transportation Act s.34 and s. 38 10	(Construction within 45m of the road or within 395m of an intersection of Hwys, 410 or 407)	Building and Land Use Permit issued by MTO		
Other:				

APPLICANT'S DECLARATION

I, _____ certify that the applicable laws designated on the above noted chart are, to the best of my
(print name)
knowledge, all of the "applicable law" for which this application for a permit must comply before a permit is issued.

_____ Date _____ Signature _____

FOR OFFICE USE ONLY

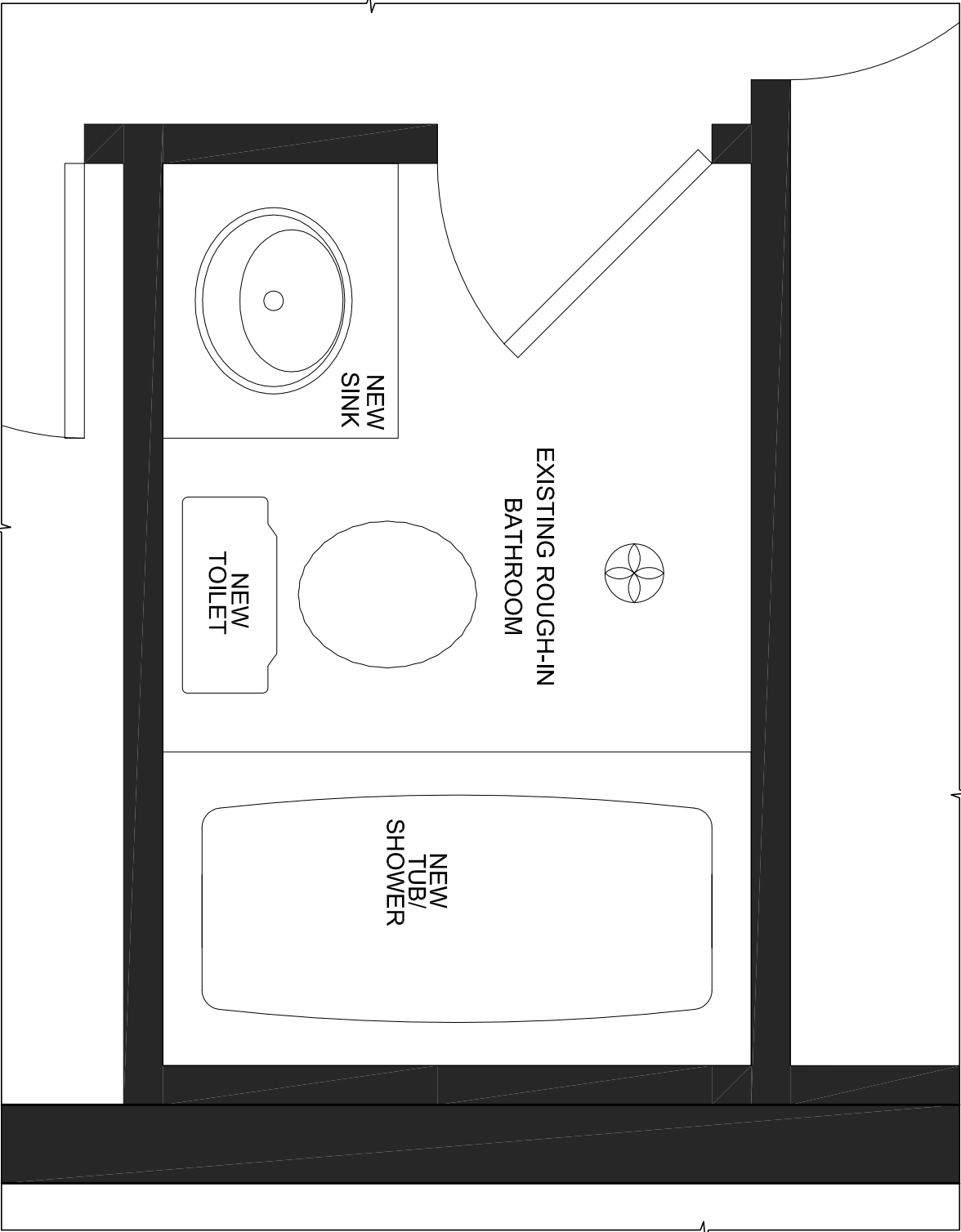

NEW PLUMBING FIXTURES

New Plumbing Fixtures

The following information is required at submission. Incomplete applications cannot be accepted.

Complete building permit application consisting of:

- ☐ Application form "Permit to Construct or Demolish"
- ☐ Schedule 1: Designer information
- ☐ Applicable Law Check List

Two sets of plans drawn to scale which must include:

- ☐ Plan Drawings
 - Provide a plan view of the existing layout for the floor area in which you propose to install the new plumbing fixtures.
 - Illustrate the proposed location of the new plumbing fixtures and label each new plumbing fixture (i.e. new sink, new laundry tub, new shower etc.)
 - Also show location of mechanical ventilation for rooms containing plumbing fixtures (where required)