



THE CORPORATION OF THE CITY OF BRAMPTON

BY-LAW

Number 186-89

To amend By-law 200-82

The council of The Corporation of the City of Brampton
ENACTS as follows:

1. By-law 200-82, as amended, is hereby further amended:
 - (a) by deleting Schedule B-1 thereto, and substituting therefor Schedule A to this by-law.
 - (b) by deleting Schedule B-3 thereto, and substituting therefor Schedule B to this by-law.

READ a FIRST, SECOND and THIRD TIME, and PASSED, in OPEN
COUNCIL, this 26th day of June 1989.



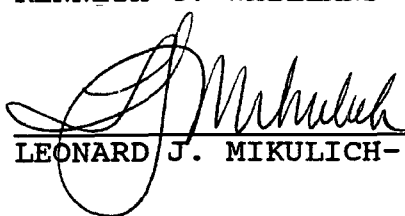

KENNETH G. WHILLANS - MAYOR

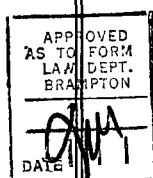
LEONARD J. MIKULICH - CLERK

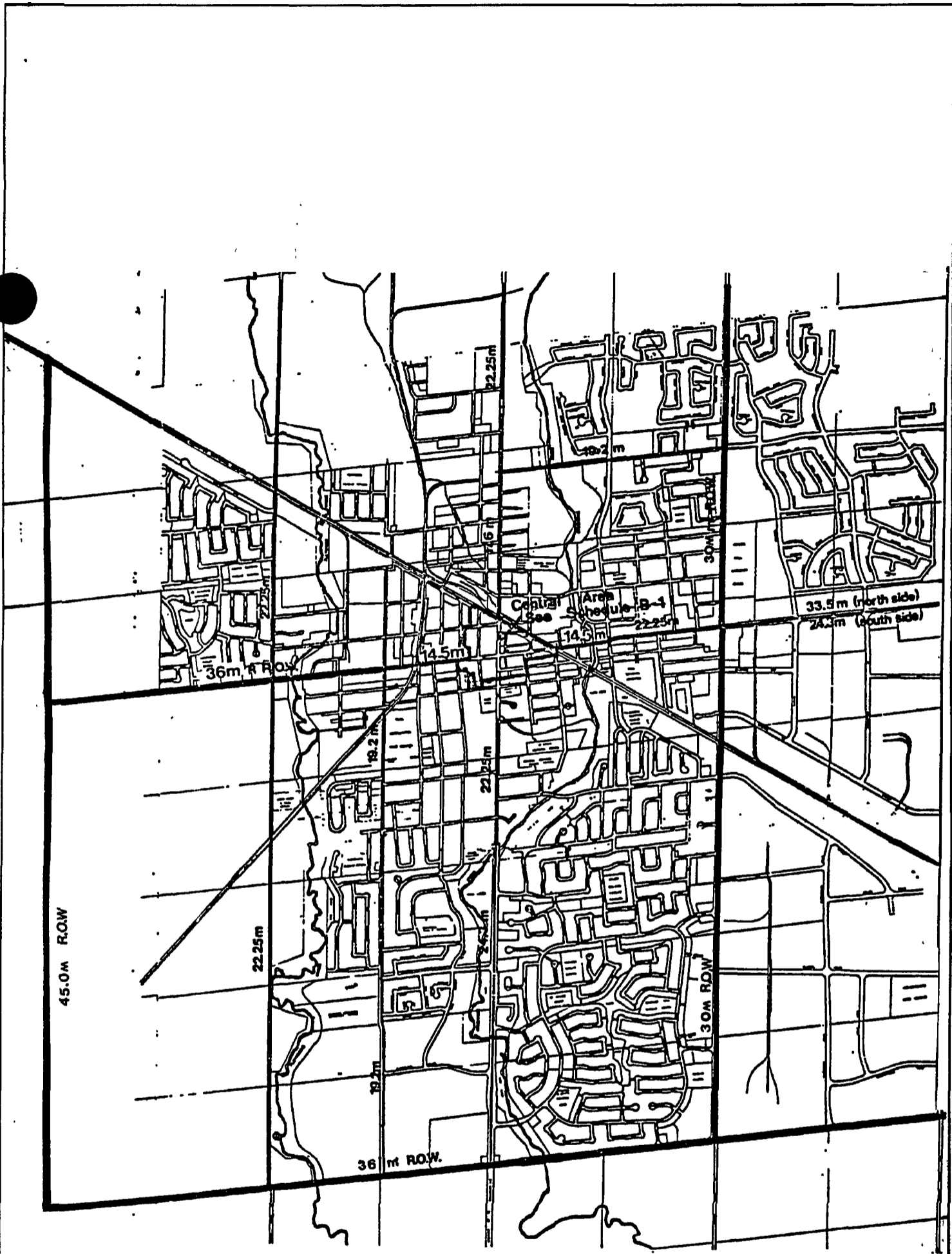
30/89/icl/am





- LEGEND**
-  Minimum Setback from Centre Line
 -  Regional Road R.O.W.
For Setback see Schedule B-3
 -  Central Area Boundary
For Details see Schedule B-2

**SCHEDULE B-1
BY-LAW 200-82**



CITY OF BRAMPTON
Planning and Development

Schedule A By-law 186-89

128000

Date: 1989 04 19 Drawn by: C J K
File no. R2-6 Map no. 59-55A

SCHEDULE B-3 TO BY-LAW 200-82

MINIMUM CENTRE LINE SETBACK

Designated Road Allowance Width	All Non-Residential Development With Access	All Non-Residential Development With No Access	All Residential Development With or Without Access
49m (160')	38m (125')	32m (105')	38m (125')
45m (150')	36m (120')	30m (100')	36m (120')
40m (130')	34m (110')	28m (90')	34m (110')
36m (120')	32m (105')	26m (86')	32m (105')
30m (100')	29m (95')	23m (75')	29m (95')
26m (86')	27m (88')	21m (68')	27m (88')
20m (66')	17m (58')	17m (58')	17m (58')

MINIMUM STREET LINE SETBACK

Designated Road Allowance Width	All Non-Residential Development With Access	All Non-Residential Development With No Access	All Residential Development With or Without Access
49m (160')	14m (45')	8m (25')	14m (45')
45m (150')	14m (45')	8m (25')	14m (45')
40m (130')	14m (45')	8m (25')	14m (45')
36m (120')	14m (45')	8m (25')	14m (45')
30m (100')	14m (45')	8m (25')	14m (45')
26m (86')	14m (45')	8m (25')	14m (45')
20m (66')	8m (25')	8m (25')	8m (25')

Note: See Schedule B-1 for designated regional roads.