

SECTION - FRONT VIEW

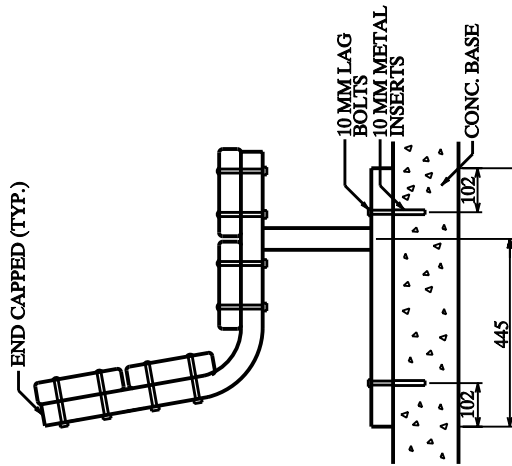

SECTION - SIDE VIEW

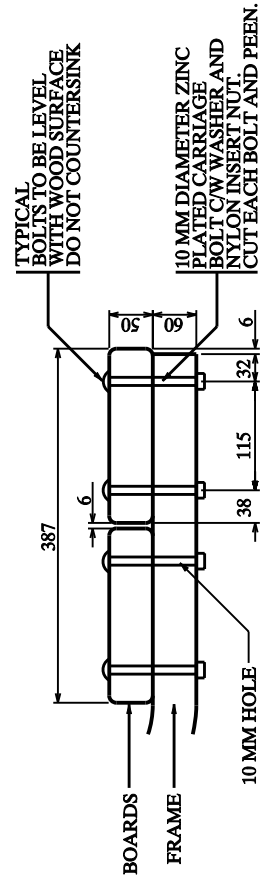

SEAT DETAIL

**NOTES:**

1. ALL DIMENSIONS ARE IN MILLIMETRES.
2. LUMBER TO BE FOUR (4) - (50 X 200 X 1524) P.T. YELLOW PINE PER BENCH.
3. FRAME TO BE 60 MM O.D., 8 MM WALL GALVANIZED PIPE.
4. CHAMFER ALL EDGES TO ELIMINATE SHARP CORNERS OR SPLINTERS. SMOOTH KNOT HOLES IF THEY EXIST.
5. TREAT ALL CUTS WITH TWO (2) COATS OF WOOD PRESERVATIVE. TREATMENTS CONTAINING CREOSOTE OR PENTACHLOROPHENOL ARE NOT ACCEPTABLE.
6. REFER TO DETAIL 871 FOR CONCRETE PAD INFORMATION.
7. REFER TO SPECIFICATIONS FOR MANUFACTURER AND MODEL NUMBER.
8. ADAPT CONCRETE ANCHOR LOCATIONS TO SPECIFIED BENCH MODEL AS PER MANUFACTURER'S INSTRUCTIONS.



**PLANNING,  
DESIGN &  
DEVELOPMENT  
DEPARTMENT**

**TITLE: WOOD PARK BENCH  
ON CONCRETE PAD**

**DRAWING NO.  
PDD 870**

REVIEWED BY: *SH [Signature]*

SCALE: **N.T.S.**

APPROVED BY: *[Signature]*

DATE: **APRIL 2003**