

TYPICAL SECTION

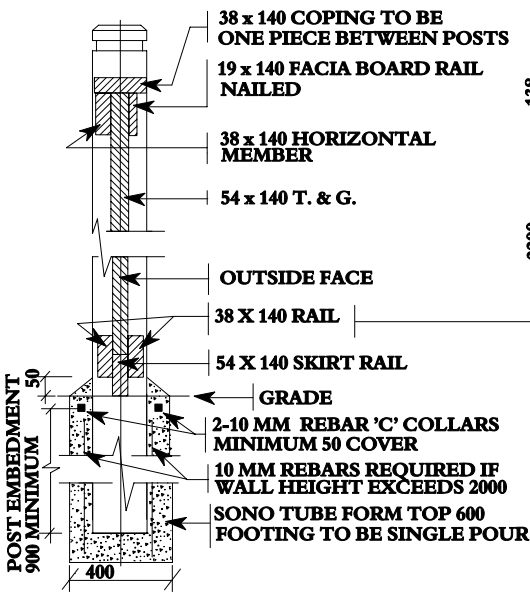

FRONT ELEVATION

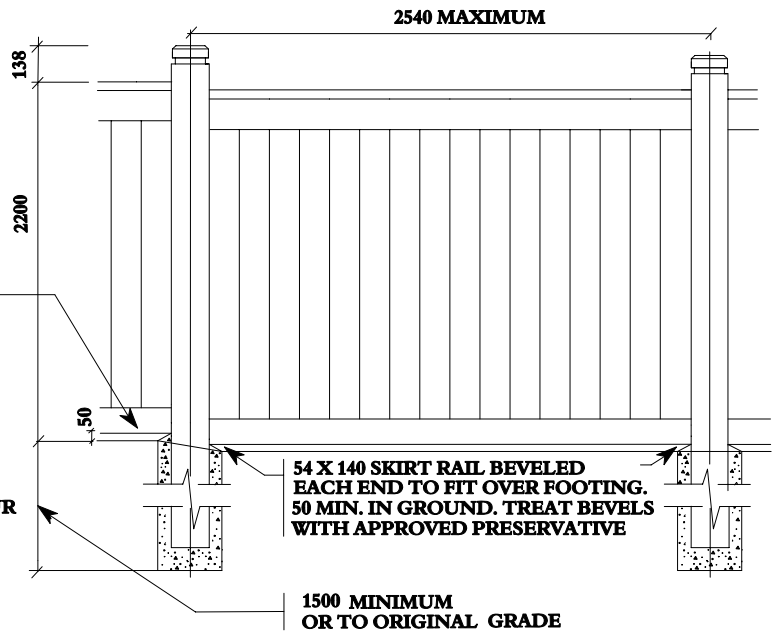

SECTION, PLAN VIEW

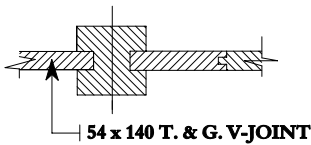

POST TOP DETAIL

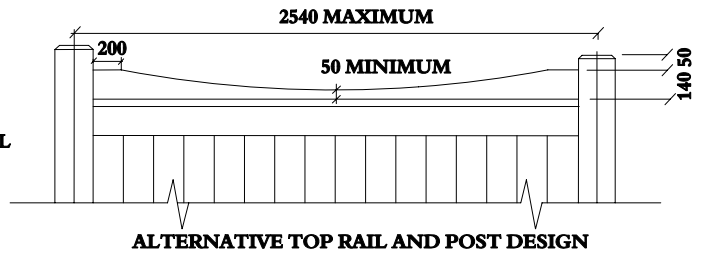
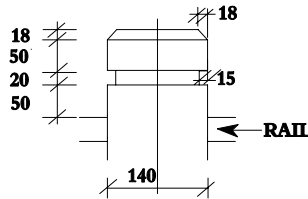

NOTES :

WOOD (GENERAL SPECIFICATIONS)

All wood shall be western red cedar selected for good appearance and free of wane and bark pockets. All torn grain and surface stain shall be eliminated by sanding or planing. Members with heavy knots and/or sap stain shall be well distributed throughout the installation. The skirt rail shall be pressure treated.

INFILL

T & G select (sound) tight knot NLGA pattern 18-(200) modified 54 mm 2 1/8" (dressed both sides) with bevelled edges on both sides

HORIZONTAL MEMBERS - Shall be 38 x 140 mm. dressed to pattern, the grade to be NLGA 204B or better select tight knot grade.

POSTS - Shall be 140 x 140 mm. dressed to pattern, the grade to be NLGA 131B*1 structural post and timber.

STAIN FOR WOOD FENCE - Stain shall consist of :

- A base of blended resins and oils in a water suspension
- Suspended solids which are not less than 21% and not greater than 31% by volume.
- V.O.C.'s (volatile organic compounds) which are not in excess of 350g/L in accordance with A.S.T.M. D-2369.
- Levels of liquid microbicides and any other potential toxic substances which are environmentally safe (not requiring Provincial or Federal registration).
- None of the following hazardous substances :
 - * Folpet [N-(trichloromethylthio) phthalimide]
 - * Bis (tributyltin) oxide
 - * Copper Naphthenate
 - * Copper 8 Quinolinate
 - * Zinc Naphthenate
- Sufficient oxide pigments to obtain desired colour tone and level of opacity (color to be approved by City for each installation).

STAIN APPLICATION - Apply two coats on clean dry wood using spray, brush or dipping methods to achieve full coverage of all exposed surfaces. Apply outdoors only in suitable weather conditions during which the temperature is between 5°C and 21°C for a period of 48 hours following applications.

FASTENERS - Including ardox nails, bolts, nuts and washers, shall be hot-dip galvanized steel.

CONCRETE - Shall be 25 MPA at 28 days minimum.

MASONRY PIERS - Of a design to be approved by the City of Brampton shall be constructed at a minimum spacing of every sixth post location.

EXECUTION

SOIL - Beneath and within 2 m. radius of any footing, shall be certified 95% standard proctor density prior to construction.

POSTS - Shall be plumb within 5 mm./m. above grade.

INFILL - Members shall be tight fitted to eliminate all gaps and rattling.

STEP FENCE - On slopes step fence panels a minimum of 50 mm. and a maximum of 150 mm. at each post.

DOUBLE POST - All direction changes greater than 20°.

NAILING

All nails galv. ardox and 75 mm. (3") unless noted otherwise. All nails to be evenly spaced and set not less than 25 mm. from edge of any member.

Rails - 3 nails to post at each end, 3 nails thru bottom front rail to vertical members and 3 nails to skirt board in staggered pattern.

Skirt Rail - 2 nails to post at each end.

Facia Board : 2 nails (50mm. - 2") each end to vertical members and 5 nails in staggered pattern along board.

Vertical Members : 2 nails (88 mm. - 3 1/2") top and bottom to rails

Coping - 2 nails thru edges to post at each end and 6 nails thru top to vertical members.

NOTE

In some cases, limited portions of wood acoustic fence may be constructed up to 2.4 m high. 150 x 200 posts are required for any 2.4 m high wood acoustic fences.

WARRANTY

The fence shall be guaranteed for three years as follows : 5 mm./m on plumb of posts and level of infill members. Gaps between infill members shall not exceed 6 mm. (1/4"). Infill members shall be tight and free of rattling.

ALL MEASUREMENTS ARE IN MILLIMETERS UNLESS STATED OTHERWISE.



**PLANNING
 DESIGN &
 DEVELOPMENT
 DEPARTMENT**

TITLE:

ACOUSTIC WOOD FENCE (TYPE 'A')

DRAWING NO.

PDD 837

REVIEWED BY:

S.H. Daubney

SCALE:

N.T.S.

APPROVED BY:

John Walsh

DATE:

FEBRUARY 2008