



THE CORPORATION OF THE CITY OF BRAMPTON

BY-LAW

Number 340-2013

To accept and assume works in
Registered Plan 43M-1549

WHEREAS the Council of The Corporation of the City of Brampton has, by resolution, decided that all works constructed and installed in accordance with the subdivision agreement for Registered Plan 43M-1549 be accepted and assumed;

AND WHEREAS Council has authorized the City Treasurer to reduce the securities held by the City to \$20,000.00 pending the completion of the walkway on Goreridge Crescent;

AND WHEREAS it is deemed expedient to accept and assume the streets on Registered Plan 43M-1549 as part of the public highway system.

NOW THEREFORE the Council of The Corporation of the City of Brampton hereby **ENACTS** as follows:

1. All of the works constructed and installed in accordance with the subdivision agreement for Registered Plan 43M-1549 are hereby accepted and assumed.
2. The lands described in Schedule A to this by-law are hereby accepted and assumed as part of the public highway system of the City of Brampton.

READ a FIRST, SECOND, AND THIRD TIME and PASSED in Open Council this 11th day of December, 2013.

Approved as to
form.
25/11/13
CG

Approved as to
content.
21/Nov/2013
[Signature]

[Signature]
Susan Fennell, Mayor

[Signature]
Peter Fay, City Clerk

SCHEDULE A TO BY-LAW NO. 340-2013

REGISTERED PLAN 43M-1549

Flower Trail, Goreridge Crescent, Via Romano Way, Wellstar Place, Rednor Drive
and Youngestar Trail.

City of Brampton
Regional Municipality of Peel

43M-1549

211-990138 PLAN 43M-1549

PLAN OF SUBDIVISION OF
 BLOCK 134, PLAN 43M-1442 AND
 PART OF THE NORTH AND SOUTH HALVES
 OF LOT 7, CONCESSION 10, (NORTHERN DIVISION)
 (GEOGRAPHIC TOWNSHIP OF TORONTO GORE)

CITY OF BRAMPTON
 REGIONAL MUNICIPALITY OF PEEI

SCALE 1:1000
 RADY-PENK & EDWARD SURVEYING LTD., O.L.S.
 METRIC
 DISTANCES SHOWN ON THIS PLAN ARE IN METRES AND CAN
 BE CONVERTED TO FEET BY DIVIDING BY 0.3048

NOTES

- M DENOTES MONUMENT FOUND
- O DENOTES MONUMENT SET
- S58 DENOTES SHORT STANDARD IRON BAR
- S18 DENOTES STANDARD IRON BAR
- # DENOTES IRON BAR
- P12 DENOTES PROPERTY IDENTIFIER NUMBER
- (940) DENOTES FRED C. CUMMINGHAM O.L.S.
- (1345) DENOTES GUIDO PAPA O.L.S.
- (892) DENOTES RADY-PENK & EDWARD SURVEYING LTD., O.L.S.
- (947) DENOTES MINISTRY OF TRANSPORTATION AND COMMUNICATIONS
- (927) DENOTES R. SKEATH O.L.S.
- (N1) DENOTES NON TANGENTIAL
- PL DENOTES PLAN 43M-1842
- PL1 DENOTES PLAN 43M-1482
- PL2 DENOTES EXPROPRIATION PLAN 960609
- PL3 DENOTES PLAN 43M-27215

ALL MONUMENTS SET ARE IRON BARS UNLESS NOTED OTHERWISE.
 BEARINGS ARE ASTROLOGICAL AND ARE REFERRED TO THE SOUTHWEST
 LIMIT OF PART 1 AS SHOWN ON PLAN 43M-25892 HAVING
 A BEARING OF N44°21'15"W

OWNER'S CERTIFICATE

- THIS IS TO CERTIFY THAT:
1. LOTS 1 TO 144, BOTH INCLUSIVE, BLOCKS 143 TO 145, HIGHWAYS, NAMELY BLOCK 146 TO 148, BOTH INCLUSIVE, 0.30 KM HWY'S, NAMELY BLOCKS 150 TO 153, BOTH INCLUSIVE, STREETS NAMELY FLOWER TRAIL, COREDRIVE, COREDRIVE 2, VIA ROMANO WAY, WELLSSTAR PLACE, REDBOR DRIVE AND YOUNGSTAR TRAIL HAVE BEEN Laid OUT IN ACCORDANCE WITH OUR INSTRUCTIONS
 2. THE STREETS ARE HEREBY DEDICATED AS PUBLIC HIGHWAYS TO THE CORPORATION OF THE CITY OF BRAMPTON.

DATED THE 5th DAY OF SEPT 2002
 YONGESTAR CUSTOM HOMES INC.

Carlo Baldassarra
 CARLO BALDASSARRA
 I HAVE THE AUTHORITY TO BIND THE CORPORATION

SURVEYOR'S CERTIFICATE

- I CERTIFY THAT:
1. THIS SURVEY AND PLAN ARE CORRECT AND IN ACCORDANCE WITH THE SURVEY ACT, THE SURVEYORS ACT AND THE LAND TILES ACT AND THE REGULATIONS MADE UNDER THEM.
 2. THE SURVEY WAS COMPLETED ON THE 6th DAY OF July 2002.

DATE July 11th 2002

C.P. EDWARD
 C. P. EDWARD
 ONTARIO LAND SURVEYOR

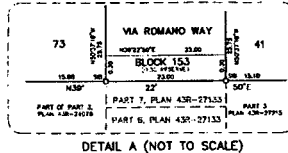

DETAIL A (NOT TO SCALE)

DETAIL D (NOT TO SCALE)

DETAIL B (NOT TO SCALE)

DETAIL C (NOT TO SCALE)

MUNICIPAL APPROVAL

211-990138
 APPROVED UNDER SECTION 51 OF
 THE PLANNING ACT, R.S.O. 1990,
 BY SR DAY OF June 2002

ATC
 REGIONAL PLANNING AND DEVELOPMENT SERVICES
 APPROVED BY REGIONAL PLANNING AND DEVELOPMENT DEPARTMENT
 COORDINATOR OF THE CITY OF BRAMPTON

rpe RADY-PENK & EDWARD SURVEYING LTD.
 ONTARIO LAND SURVEYORS
 465 WELSON AVENUE, DOWNSVIEW, ONTARIO
 (416) 635-5000 Fax (416) 635-5001
 E Mail rpesurvey@opers.com
 DRAWN: P.M./C.D.S. CHECKED: C.P.E.

TOTAL SUBDIVISION AREA=10.896 ha.

JUL 25, 2002 - RR0614
 SEPT 05, 2002 - DB0046C

JOB NO. 99-175 CAD FILE 99176PH16
 REGISTRATION DATE JULY/02

A3M-1549

By-law 340-2013