



THE CORPORATION OF THE CITY OF BRAMPTON

BY-LAW

Number 221-2014

To accept and assume works in
Registered Plan 43M-1769

WHEREAS the Council of The Corporation of the City of Brampton has, by resolution, decided that all works constructed and installed in accordance with the subdivision agreement for Registered Plan 43M-1769 be accepted and assumed;

AND WHEREAS Council has authorized the City Treasurer to release the securities held by the City;

AND WHEREAS it is deemed expedient to accept and assume the streets and street widening block on Registered Plan 43M-1769 as part of the public highway system.

NOW THEREFORE the Council of The Corporation of the City of Brampton hereby **ENACTS** as follows:

1. All of the works constructed and installed in accordance with the subdivision agreement for Registered Plan 43M-1769 are hereby accepted and assumed.
2. The lands described in Schedule A to this by-law are hereby accepted and assumed as part of the public highway system of the City of Brampton.

READ a **FIRST, SECOND, AND THIRD TIME** and **PASSED** in Open Council this ^{6TH} day of ~~July~~^{August}, 2014. ^{2ND} **A**

Approved as to form.
21 Jul 14

Approved as to content.
18 July 2014

Susan Fennell, Mayor

Peter Fay, City Clerk

SCHEDULE A TO BY-LAW NO. 221-2014

REGISTERED PLAN 43M-1769

Cameo Court, Fahey Drive, Young Drive, Pillar Road, Seastar Road, Fallharvest Avenue, Beethoven Court, James Potter Road, Hepburn Gate and street widening block 253 to be part of Chinguacousy Road.

City of Brampton
Regional Municipality of Peel

NOTES: ANY AND ALL DIMENSIONS ON THIS PLAN ARE IN METRES AND CAN BE CONVERTED TO FEET BY DIVISION BY 0.3048.

DRIVE TABLE

DRIVE	START	END	WIDTH
YOUNG DRIVE	0+00	0+100	12.00
YOUNG DRIVE	0+100	0+200	12.00
YOUNG DRIVE	0+200	0+300	12.00
YOUNG DRIVE	0+300	0+400	12.00
YOUNG DRIVE	0+400	0+500	12.00
YOUNG DRIVE	0+500	0+600	12.00
YOUNG DRIVE	0+600	0+700	12.00
YOUNG DRIVE	0+700	0+800	12.00
YOUNG DRIVE	0+800	0+900	12.00
YOUNG DRIVE	0+900	1+000	12.00
YOUNG DRIVE	1+000	1+100	12.00
YOUNG DRIVE	1+100	1+200	12.00
YOUNG DRIVE	1+200	1+300	12.00
YOUNG DRIVE	1+300	1+400	12.00
YOUNG DRIVE	1+400	1+500	12.00
YOUNG DRIVE	1+500	1+600	12.00
YOUNG DRIVE	1+600	1+700	12.00
YOUNG DRIVE	1+700	1+800	12.00
YOUNG DRIVE	1+800	1+900	12.00
YOUNG DRIVE	1+900	2+000	12.00
YOUNG DRIVE	2+000	2+100	12.00
YOUNG DRIVE	2+100	2+200	12.00
YOUNG DRIVE	2+200	2+300	12.00
YOUNG DRIVE	2+300	2+400	12.00
YOUNG DRIVE	2+400	2+500	12.00
YOUNG DRIVE	2+500	2+600	12.00
YOUNG DRIVE	2+600	2+700	12.00
YOUNG DRIVE	2+700	2+800	12.00
YOUNG DRIVE	2+800	2+900	12.00
YOUNG DRIVE	2+900	3+000	12.00
YOUNG DRIVE	3+000	3+100	12.00
YOUNG DRIVE	3+100	3+200	12.00
YOUNG DRIVE	3+200	3+300	12.00
YOUNG DRIVE	3+300	3+400	12.00
YOUNG DRIVE	3+400	3+500	12.00
YOUNG DRIVE	3+500	3+600	12.00
YOUNG DRIVE	3+600	3+700	12.00
YOUNG DRIVE	3+700	3+800	12.00
YOUNG DRIVE	3+800	3+900	12.00
YOUNG DRIVE	3+900	4+000	12.00
YOUNG DRIVE	4+000	4+100	12.00
YOUNG DRIVE	4+100	4+200	12.00
YOUNG DRIVE	4+200	4+300	12.00
YOUNG DRIVE	4+300	4+400	12.00
YOUNG DRIVE	4+400	4+500	12.00
YOUNG DRIVE	4+500	4+600	12.00
YOUNG DRIVE	4+600	4+700	12.00
YOUNG DRIVE	4+700	4+800	12.00
YOUNG DRIVE	4+800	4+900	12.00
YOUNG DRIVE	4+900	5+000	12.00
YOUNG DRIVE	5+000	5+100	12.00
YOUNG DRIVE	5+100	5+200	12.00
YOUNG DRIVE	5+200	5+300	12.00
YOUNG DRIVE	5+300	5+400	12.00
YOUNG DRIVE	5+400	5+500	12.00
YOUNG DRIVE	5+500	5+600	12.00
YOUNG DRIVE	5+600	5+700	12.00
YOUNG DRIVE	5+700	5+800	12.00
YOUNG DRIVE	5+800	5+900	12.00
YOUNG DRIVE	5+900	6+000	12.00
YOUNG DRIVE	6+000	6+100	12.00
YOUNG DRIVE	6+100	6+200	12.00
YOUNG DRIVE	6+200	6+300	12.00
YOUNG DRIVE	6+300	6+400	12.00
YOUNG DRIVE	6+400	6+500	12.00
YOUNG DRIVE	6+500	6+600	12.00
YOUNG DRIVE	6+600	6+700	12.00
YOUNG DRIVE	6+700	6+800	12.00
YOUNG DRIVE	6+800	6+900	12.00
YOUNG DRIVE	6+900	7+000	12.00
YOUNG DRIVE	7+000	7+100	12.00
YOUNG DRIVE	7+100	7+200	12.00
YOUNG DRIVE	7+200	7+300	12.00
YOUNG DRIVE	7+300	7+400	12.00
YOUNG DRIVE	7+400	7+500	12.00
YOUNG DRIVE	7+500	7+600	12.00
YOUNG DRIVE	7+600	7+700	12.00
YOUNG DRIVE	7+700	7+800	12.00
YOUNG DRIVE	7+800	7+900	12.00
YOUNG DRIVE	7+900	8+000	12.00
YOUNG DRIVE	8+000	8+100	12.00
YOUNG DRIVE	8+100	8+200	12.00
YOUNG DRIVE	8+200	8+300	12.00
YOUNG DRIVE	8+300	8+400	12.00
YOUNG DRIVE	8+400	8+500	12.00
YOUNG DRIVE	8+500	8+600	12.00
YOUNG DRIVE	8+600	8+700	12.00
YOUNG DRIVE	8+700	8+800	12.00
YOUNG DRIVE	8+800	8+900	12.00
YOUNG DRIVE	8+900	9+000	12.00
YOUNG DRIVE	9+000	9+100	12.00
YOUNG DRIVE	9+100	9+200	12.00
YOUNG DRIVE	9+200	9+300	12.00
YOUNG DRIVE	9+300	9+400	12.00
YOUNG DRIVE	9+400	9+500	12.00
YOUNG DRIVE	9+500	9+600	12.00
YOUNG DRIVE	9+600	9+700	12.00
YOUNG DRIVE	9+700	9+800	12.00
YOUNG DRIVE	9+800	9+900	12.00
YOUNG DRIVE	9+900	10+000	12.00
YOUNG DRIVE	10+000	10+100	12.00
YOUNG DRIVE	10+100	10+200	12.00
YOUNG DRIVE	10+200	10+300	12.00
YOUNG DRIVE	10+300	10+400	12.00
YOUNG DRIVE	10+400	10+500	12.00
YOUNG DRIVE	10+500	10+600	12.00
YOUNG DRIVE	10+600	10+700	12.00
YOUNG DRIVE	10+700	10+800	12.00
YOUNG DRIVE	10+800	10+900	12.00
YOUNG DRIVE	10+900	11+000	12.00
YOUNG DRIVE	11+000	11+100	12.00
YOUNG DRIVE	11+100	11+200	12.00
YOUNG DRIVE	11+200	11+300	12.00
YOUNG DRIVE	11+300	11+400	12.00
YOUNG DRIVE	11+400	11+500	12.00
YOUNG DRIVE	11+500	11+600	12.00
YOUNG DRIVE	11+600	11+700	12.00
YOUNG DRIVE	11+700	11+800	12.00
YOUNG DRIVE	11+800	11+900	12.00
YOUNG DRIVE	11+900	12+000	12.00
YOUNG DRIVE	12+000	12+100	12.00
YOUNG DRIVE	12+100	12+200	12.00
YOUNG DRIVE	12+200	12+300	12.00
YOUNG DRIVE	12+300	12+400	12.00
YOUNG DRIVE	12+400	12+500	12.00
YOUNG DRIVE	12+500	12+600	12.00
YOUNG DRIVE	12+600	12+700	12.00
YOUNG DRIVE	12+700	12+800	12.00
YOUNG DRIVE	12+800	12+900	12.00
YOUNG DRIVE	12+900	13+000	12.00
YOUNG DRIVE	13+000	13+100	12.00
YOUNG DRIVE	13+100	13+200	12.00
YOUNG DRIVE	13+200	13+300	12.00
YOUNG DRIVE	13+300	13+400	12.00
YOUNG DRIVE	13+400	13+500	12.00
YOUNG DRIVE	13+500	13+600	12.00
YOUNG DRIVE	13+600	13+700	12.00
YOUNG DRIVE	13+700	13+800	12.00
YOUNG DRIVE	13+800	13+900	12.00
YOUNG DRIVE	13+900	14+000	12.00
YOUNG DRIVE	14+000	14+100	12.00
YOUNG DRIVE	14+100	14+200	12.00
YOUNG DRIVE	14+200	14+300	12.00
YOUNG DRIVE	14+300	14+400	12.00
YOUNG DRIVE	14+400	14+500	12.00
YOUNG DRIVE	14+500	14+600	12.00
YOUNG DRIVE	14+600	14+700	12.00
YOUNG DRIVE	14+700	14+800	12.00
YOUNG DRIVE	14+800	14+900	12.00
YOUNG DRIVE	14+900	15+000	12.00
YOUNG DRIVE	15+000	15+100	12.00
YOUNG DRIVE	15+100	15+200	12.00
YOUNG DRIVE	15+200	15+300	12.00
YOUNG DRIVE	15+300	15+400	12.00
YOUNG DRIVE	15+400	15+500	12.00
YOUNG DRIVE	15+500	15+600	12.00
YOUNG DRIVE	15+600	15+700	12.00
YOUNG DRIVE	15+700	15+800	12.00
YOUNG DRIVE	15+800	15+900	12.00
YOUNG DRIVE	15+900	16+000	12.00
YOUNG DRIVE	16+000	16+100	12.00
YOUNG DRIVE	16+100	16+200	12.00
YOUNG DRIVE	16+200	16+300	12.00
YOUNG DRIVE	16+300	16+400	12.00
YOUNG DRIVE	16+400	16+500	12.00
YOUNG DRIVE	16+500	16+600	12.00
YOUNG DRIVE	16+600	16+700	12.00
YOUNG DRIVE	16+700	16+800	12.00
YOUNG DRIVE	16+800	16+900	12.00
YOUNG DRIVE	16+900	17+000	12.00
YOUNG DRIVE	17+000	17+100	12.00
YOUNG DRIVE	17+100	17+200	12.00
YOUNG DRIVE	17+200	17+300	12.00
YOUNG DRIVE	17+300	17+400	12.00
YOUNG DRIVE	17+400	17+500	12.00
YOUNG DRIVE	17+500	17+600	12.00
YOUNG DRIVE	17+600	17+700	12.00
YOUNG DRIVE	17+700	17+800	12.00
YOUNG DRIVE	17+800	17+900	12.00
YOUNG DRIVE	17+900	18+000	12.00
YOUNG DRIVE	18+000	18+100	12.00
YOUNG DRIVE	18+100	18+200	12.00
YOUNG DRIVE	18+200	18+300	12.00
YOUNG DRIVE	18+300	18+400	12.00
YOUNG DRIVE	18+400	18+500	12.00
YOUNG DRIVE	18+500	18+600	12.00
YOUNG DRIVE	18+600	18+700	12.00
YOUNG DRIVE	18+700	18+800	12.00
YOUNG DRIVE	18+800	18+900	12.00
YOUNG DRIVE	18+900	19+000	12.00
YOUNG DRIVE	19+000	19+100	12.00
YOUNG DRIVE	19+100	19+200	12.00
YOUNG DRIVE	19+200	19+300	12.00
YOUNG DRIVE	19+300	19+400	12.00
YOUNG DRIVE	19+400	19+500	12.00
YOUNG DRIVE	19+500	19+600	12.00
YOUNG DRIVE	19+600	19+700	12.00
YOUNG DRIVE	19+700	19+800	12.00
YOUNG DRIVE	19+800	19+900	12.00
YOUNG DRIVE	19+900	20+000	12.00

EAST HALF OF LOT 3, CONCESSION 3, WEST OF HURONTARIO STREET

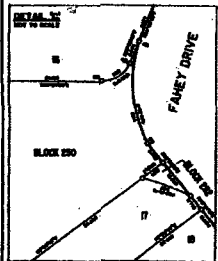
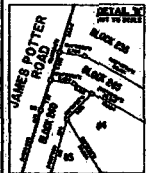
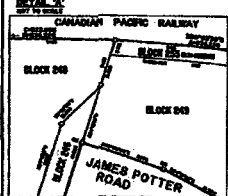
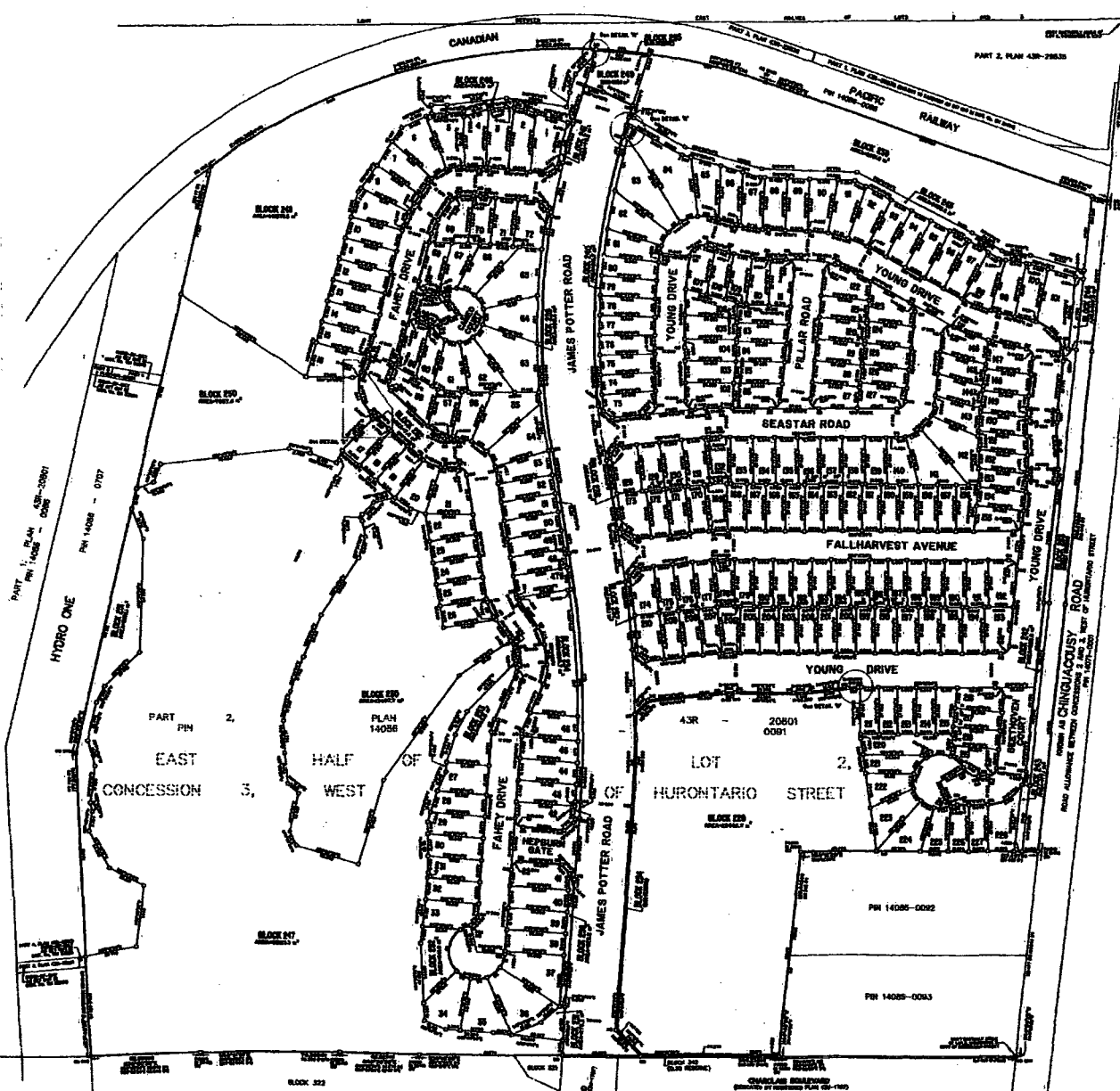

PLAN 43M-1769

I CERTIFY THAT THIS PLAN IS REGISTERED IN THE LAND SURVEY OFFICE FOR THE LAND TITLED OWNERS OF PEEL, INC. AS OF THE 21st DAY OF MAY, 1998 AND EXTENDED IN THE OFFICE OF THE REGISTRAR FOR PROPERTY SURVEYS NO. 14086-0001 AND THE EXTENDED COORDINATES ARE REGISTERED AS PLAN DOCUMENT NO. 14086-0001.

L. Christie
Act. Land Registrar

PLAN OF SUBDIVISION OF PART OF THE EAST HALF OF LOT 2, CONCESSION 3, WEST OF HURONTARIO STREET CITY OF BRAMPTON REGIONAL MUNICIPALITY OF PEEL SCALE 1:5000



NOTES

1. THIS PLAN IS A PART OF PLAN 43M-1769.
2. THE TOTAL AREA OF THIS PLAN IS 22.5300 H.A.
3. THE TOTAL AREA OF THIS PLAN IS 22.5300 H.A.
4. THE TOTAL AREA OF THIS PLAN IS 22.5300 H.A.

TOTAL AREA OF SUBDIVISION = 22.5300 H.A.

OWNER'S CERTIFICATE

I, THE REGISTRAR, HAVE EXAMINED THE PLAN AND THE INFORMATION PROVIDED TO ME BY THE SURVEYOR AND I AM SATISFIED THAT THE PLAN IS CORRECT AND THAT THE INFORMATION IS TRUE AND ACCURATE.

ALTOFF INVESTMENTS LIMITED

SURVEYOR'S CERTIFICATE

I, THE SURVEYOR, HAVE EXAMINED THE PLAN AND THE INFORMATION PROVIDED TO ME BY THE SURVEYOR AND I AM SATISFIED THAT THE PLAN IS CORRECT AND THAT THE INFORMATION IS TRUE AND ACCURATE.

W. J. J. J.

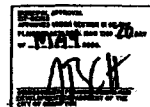

SCHAEFFER & DZALDOV LIMITED
ONTARIO LAND SURVEYORS

By-law 221-2014