



THE CORPORATION OF THE CITY OF BRAMPTON

BY-LAW

Number 164-97

To amend By-law 139-84, as amended.

The Council of The Corporation of the City of Brampton ENACTS as follows:

1. By-law 139-84, as amended, is hereby further amended:

- (1) by changing, on Sheet 7 of Schedule A thereto, the zoning designation of the lands shown outlined on Schedule A to this by-law from HIGHWAY COMMERCIAL TWO – SECTION 624 (HC2-SECTION 624) to COMMERCIAL ONE - SECTION 625 (C1-SECTION 625).
- (2) by deleting therefrom, SCHEDULE C – SECTION 625.
- (3) by deleting from Section 3.2(2), Schedule C – Section 625.
- (4) by deleting therefrom, Section 624 in its entirety.
- (5) by deleting therefrom, Section 625 and substituting therefore the following:

"625 The lands designated C1-SECTION 625 on Sheet 7 of
Schedule A to this by-law:

625.1 shall only be used for those purposes permitted in a C1 zone
by Section 23.1.1.

625.2 shall be subject to the following requirements and
restrictions:

- (a) Minimum Interior Side Yard Width: 15.0 metres;
- (b) Minimum Exterior Side Yard Width: 15.0 metres;
- (c) Minimum Rear Yard Depth: 4.5 metres;
- (d) A canopy may project into the minimum required yards to a maximum of 3.0 metres; and,
- (e) Minimum Landscaped Open Space: 3.0 metres abutting all public streets and institutional zones, except at approved driveway locations.

625.3 shall also be subject to the requirements and restrictions relating to the C1 zone and all the general provisions of this by-law which are not in conflict with those set out in Section 625.2."

READ a FIRST, SECOND and THIRD TIME, and PASSED, in OPEN COUNCIL, this 16th day of July, 1997.

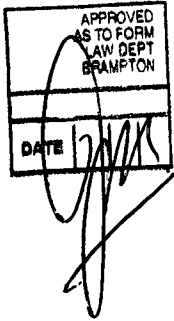



PETER ROBERTSON - MAYOR



LEONARD J. MIKULICH - CITY CLERK

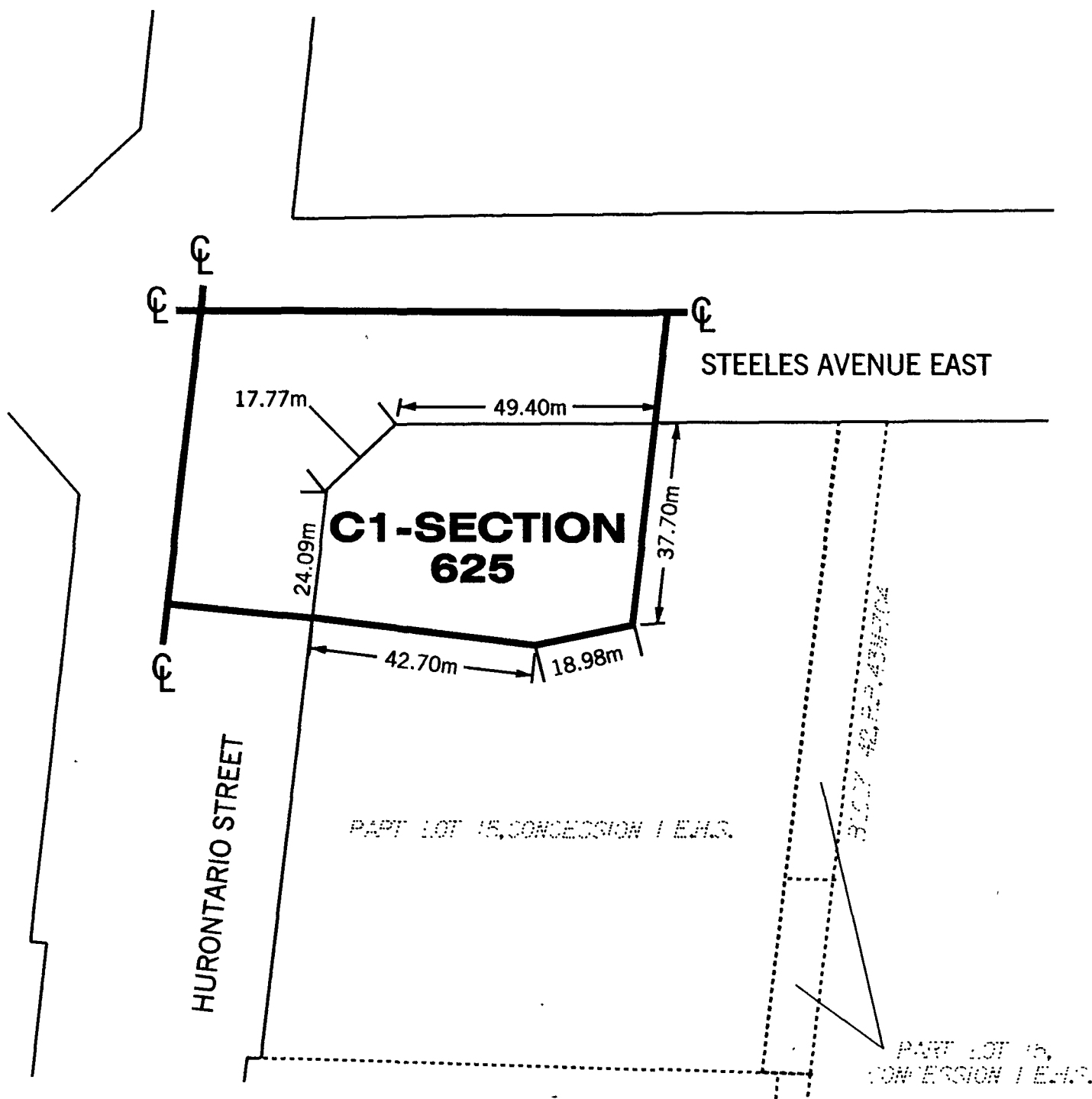

PART LOT 15, CONCESSION 1 E.H.S.

PART LOT 15, CONCESSION 1 E.H.S.

PART LOT 15, CONCESSION 1 E.H.S.

LEGEND

- ZONE BOUNDARY
- Ⓢ** CENTRELINE OF ORIGINAL ROAD ALLOWANCE
- m** METRES

PART LOT 15, CONCESSION 1 E.H.S.
BY-LAW 139-84 **SCHEDULE A**
By-Law 164-97 **Schedule A**

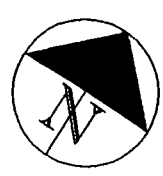

CITY OF BRAMPTON
 Planning and Building
 Date: 1997 05 14 Drawn by: CJK
 File no. T1E15.13 Map no. 76-39J

ROOK
SHELDRAKE
CT

GOLF
VIEW DR

STEELES AVENUE EAST

CL
CHATTERTON
CT

SUBJECT PROPERTY

STORNWOOD
CT

GARNY
PARSONBY
CT
RD
MANS
RD
CT

TINA CT

*2 SIR LOU
DR

HURONTARIO STREET SOUTH

SUGAR
CREEK
LN

TURTLE CREEK BLVD
SEMINOLE
DR

INVERARY DR

COUNTY COURT BLVD.

ROSSBANK



Key Map By-Law

164-97

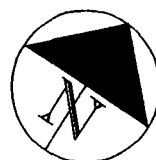

CITY OF BRAMPTON
Planning and Building

Date: 1997 02 26

Drawn by: CJK

File no. T1E15.13

Map no. 76-39G