



THE CORPORATION OF THE CITY OF BRAMPTON

BY-LAW

Number 14-91

To amend By-law 151-88 (part of
Lot 13, Concession 1, E.H.S.
geographic Township of Chinguacousy)

The council of The Corporation of the City of Brampton
ENACTS as follows:

1. By-law 151-88, as amended, is hereby further amended:

- (1) by changing on Schedule A, Sheet 25D thereto, the zoning designation of the lands shown outlined on Schedule A to this by-law from "INSTITUTIONAL TWO (I2)" to INSTITUTIONAL ONE (I1)", such lands being part of Lot 13, Concession 1, E.H.S., in the geographic Township of Chinguacousy, now in the City of Brampton.

READ a FIRST, SECOND and THIRD TIME, and PASSED, in OPEN
COUNCIL, this 28th day of January 1991.

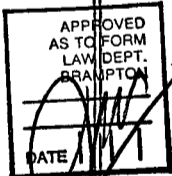



PAUL BEISEL - MAYOR



LEONARD J. MIKULICH - CLERK

62/90/un.church.bylaw

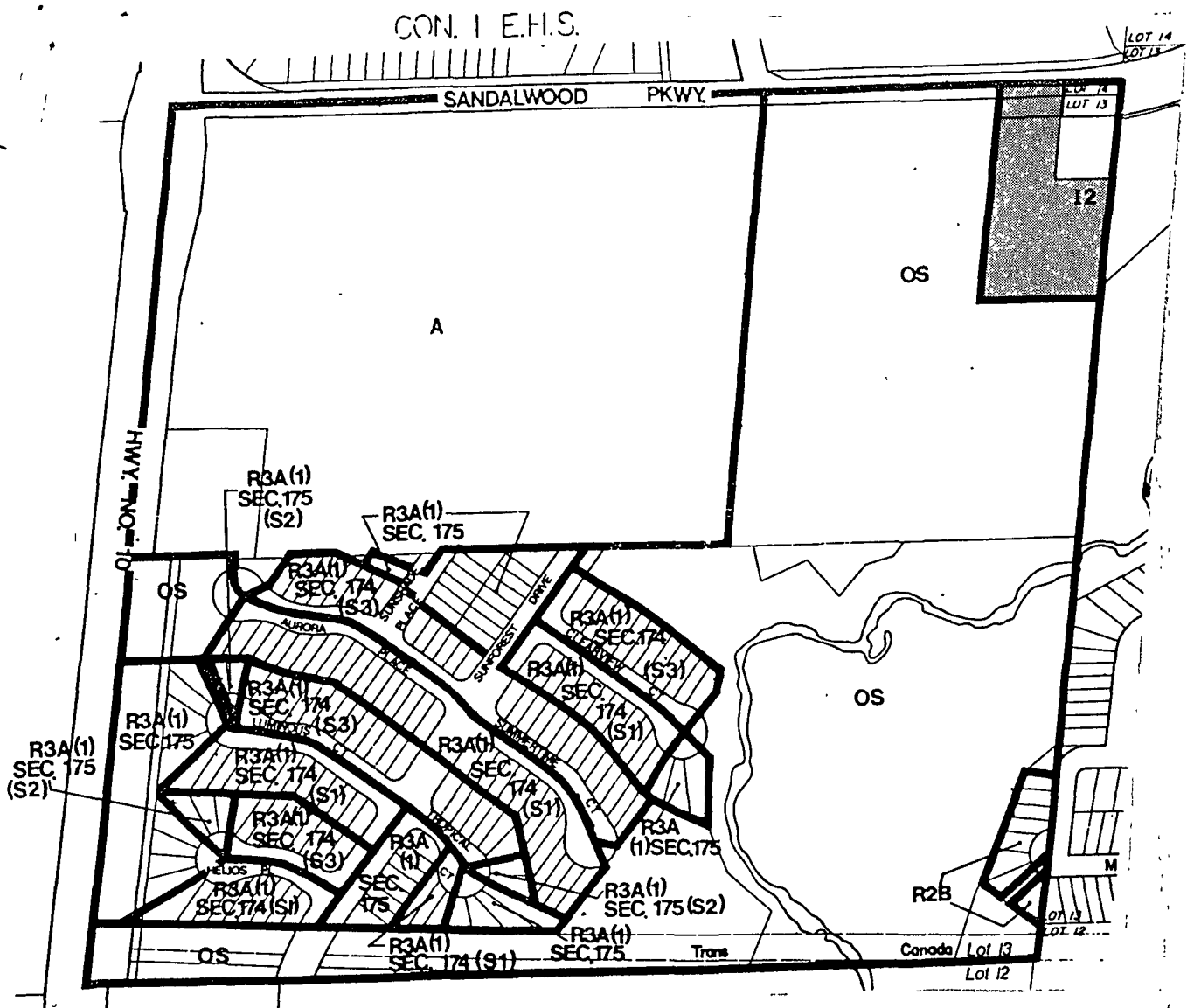

 LANDS SUBJECT TO THIS AMENDMENT

SCHEDULE A-SHEET 25D
BY-LAW 151-88 (CHING.)

By-Law 14-91 Schedule A



CITY OF BRAMPTON
Planning and Development

Date: 1990 09 19 Drawn by: CJK
File no. Map no. 25-58A

IN THE MATTER OF the Planning Act,
1983, section 34;

AND IN THE MATTER OF the City of
Brampton By-law 14-91.

DECLARATION

I, LEONARD J. MIKULICH, of the City of Brampton, in
the Region of Peel, DO SOLEMNLY DECLARE THAT:

1. I am the Clerk of The Corporation of the City
of Brampton and as such have knowledge of the
matters herein declared.
2. By-law 14-91 was passed by the Council of the
Corporation of the City of Brampton at its
meeting held on January 28th, 1991.
3. Written notice of By-law 14-91 as required by
section 34 (17) of the Planning Act, 1983 was
given on January 31st, 1991, in the manner and
in the form and to the persons and agencies
prescribed by the Planning Act, 1983.
4. No notice of appeal under section 34 (18) of
the Planning Act, 1983 has been filed with me
to the date of this declaration.

DECLARED before me at the)
City of Brampton in the)
Region of Peel this 28th)
day of February, 1991.)

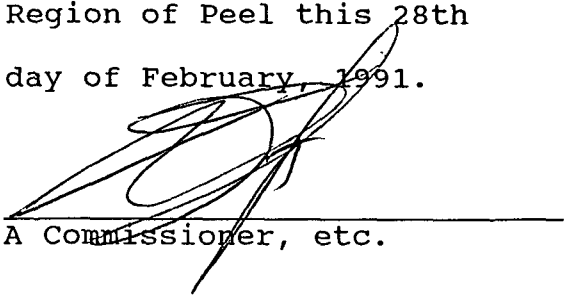

A Commissioner, etc.)

